

	Series	Section Page	Max. Holding Capacity N [lbf.]								Height Under Clamping Bar mm [inch]							Overall Height mm [inch]																			
			0 to 1000 [0 to 225]	1000 to 2000 [225 to 450]	2000 to 3000 [450 to 675]	3000 to 5000 [675 to 1125]	5000 to 7000 [1125 to 1575]	7000 to 10000 [1575 to 2250]	10000+ [2250+]	0 to 25 [0 to 0.98]	25 to 40 [0.98 to 1.57]	40 to 55 [1.57 to 2.17]	55 to 70 [2.17 to 2.76]	70 to 85 [2.76 to 3.35]	85 to 100 [3.35 to 3.94]	100+ [3.94+]	0 to 50 [0 to 1.97]	50 to 100 [1.97 to 3.94]	100 to 125 [3.94 to 4.92]	125 to 150 [4.92 to 5.91]	150 to 175 [5.91 to 6.89]	175 to 200 [6.89 to 7.87]	200 to 225 [7.87 to 8.86]	225 to 250 [8.86 to 9.84]	250 to 275 [9.84 to 10.83]	275+ [10.83+]											
	2002	1.3																																			
	2007	1.7																																			
	2010	1.9																																			
	201	1.11																																			
	202	1.13																																			
	207	1.17																																			
	210	1.21																																			
247	1.23																																				
267	1.23																																				
	5905	1.27																																			
	5910	1.27																																			
	5915	1.27																																			
	5105	1.29																																			
	5110	1.29																																			
	528	1.31																																			
	548/578	1.32																																			
	533/535	1.33																																			
	558	1.35																																			
	91090	1.36																																			
	317	1.37																																			
	527	1.39																																			
	7-101	1.40																																			
	7-58	1.40																																			
	7-59	1.40																																			
	7-60	1.40																																			
	229	1.41																																			
	501	1.43																																			
	503	1.43																																			
	505	1.43																																			
	506	1.43																																			



Overall Length mm [inch]										Overall Width mm [inch]										Suitable Application Area										Standard Material				Arm Style		Mounting Style			Service Environment	
50 to 75 [1.97 to 2.95]	75 to 100 [2.95 to 3.94]	100 to 125 [3.94 to 4.92]	125 to 150 [4.92 to 5.91]	150 to 175 [5.91 to 6.89]	175 to 200 [6.89 to 7.87]	200 to 225 [7.87 to 8.86]	225 to 250 [8.86 to 9.84]	0 to 20 [0 to 0.78]	20 to 40 [0.78 to 1.57]	40 to 60 [1.57 to 2.36]	60 to 80 [2.36 to 3.15]	80 to 100 [3.15 to 3.94]	100+ [3.94+]	Welding	Assembly	Checking Fixtures	Machining	Woodworking	Closures	Food Processing	Duty Cycle	Steel	Stainless Steel	Toggle Lock Plus	Accom. Workpiece Variation	U-Bar Version	Solid Arm Version	Straight Base	Flanged Base	Welded	Normal	Harsh/Dirty								
█	█	█	█	█	█	█	█	█	█	█	█	█	○	●	●	●	●	●	●	○	○	✓		✓	✓	✓	✓	✓	✓	✓	✓									
	█	█	█	█	█	█	█	█	█	█	█	█	○	●	●	●	●	●	●	○	○	✓		✓	✓	✓	✓	✓	✓	✓	✓	✓								
		█	█	█	█	█	█	█	█	█	█	█	○	●	●	●	●	●	●	○	○	✓		✓	✓	✓	✓	✓	✓	✓	✓	✓								
█			█	█	█	█	█	█	█	█	█	█	○	●	●	●	●	●	●	○	○	✓	✓		✓	✓	✓	✓	✓	✓	✓	✓								
█				█	█	█	█	█	█	█	█	█	○	●	●	●	●	●	●	○	○	✓	✓		✓	✓	✓	✓	✓	✓	✓	✓								
	█	█	█	█	█	█	█	█	█	█	█	█	○	●	●	●	●	●	●	○	○	✓	✓	✓		✓	✓	✓	✓	✓	✓	✓								
		█	█	█	█	█	█	█	█	█	█	█	○	●	●	●	●	●	●	○	○	✓	✓	✓		✓	✓	✓	✓	✓	✓	✓								
			█	█	█	█	█	█	█	█	█	█	○	●	●	●	●	●	●	○	○	✓	✓	✓		✓	✓	✓	✓	✓	✓	✓								
				█	█	█	█	█	█	█	█	█	○	●	●	●	●	●	●	○	○	✓	✓	✓		✓	✓	✓	✓	✓	✓	✓								
					█	█	█	█	█	█	█	█	○	●	●	●	●	●	●	○	○	✓	✓	✓		✓	✓	✓	✓	✓	✓	✓								
						█	█	█	█	█	█	█	○	●	●	●	●	●	●	○	○	✓	✓	✓		✓	✓	✓	✓	✓	✓	✓								
							█	█	█	█	█	█	○	●	●	●	●	●	●	○	○	✓	✓	✓		✓	✓	✓	✓	✓	✓	✓								
								█	█	█	█	█	○	●	●	●	●	●	●	○	○	✓	✓	✓		✓	✓	✓	✓	✓	✓	✓								
									█	█	█	█	○	●	●	●	●	●	●	○	○	✓	✓	✓		✓	✓	✓	✓	✓	✓	✓								
										█	█	█	○	●	●	●	●	●	●	○	○	✓	✓	✓		✓	✓	✓	✓	✓	✓	✓								
											█	█	○	●	●	●	●	●	●	○	○	✓	✓	✓		✓	✓	✓	✓	✓	✓	✓								
												█	○	●	●	●	●	●	●	○	○	✓	✓	✓		✓	✓	✓	✓	✓	✓	✓								
													○	●	●	●	●	●	●	○	○	✓	✓	✓		✓	✓	✓	✓	✓	✓	✓								
													○	●	●	●	●	●	●	○	○	✓	✓	✓		✓	✓	✓	✓	✓	✓	✓								
													○	●	●	●	●	●	●	○	○	✓	✓	✓		✓	✓	✓	✓	✓	✓	✓								

● Excellent/High ○ Fair/Medium ● Poor/Low ⊗ Not Recommended

Series 2002 Product Overview

Features:

- Large hand clearance for improved safety
- Bolt pattern interchangeable with 202 Series
- Three times the holding capacity of 202 Series
- Hardened bushings at key pivot points
- Near vertical clamping contact
- BLK models feature a black, non-reflective finish













Applications:

- Checking fixtures
- Assembly & test
- Light machining
- Woodworking

Also Available:

See page 7.1 for accessories
Accepts M6 or 1/4 spindle accessories

Covered under one or more U.S./International Patents

<p>2002-U Flanged Base U-Bar</p> 	<p>2002-U-LS-BLK ⓘ Blackout Series Flanged Base U-Bar</p> 	<p>2002-S Flanged Base Solid Bar</p> 	<p>2002-UB Straight Base U-Bar</p> 	<p>2002-UB-LS-BLK ⓘ Blackout Series Straight Base U-Bar</p> 
<p>2002-SB Straight Base Solid Bar</p> 	<p>2002-UR Flanged Base U-Bar with DE-STA-CO® Toggle Lock Plus</p> 	<p>2002-SR ⓘ Flanged Base Solid Bar with DE-STA-CO® Toggle Lock Plus</p> 	<p>2002-UBR Straight Base U-Bar with DE-STA-CO® Toggle Lock Plus</p> 	<p>2002-SBR ⓘ Straight Base Solid Bar with DE-STA-CO® Toggle Lock Plus</p> 
<p>2002-U207 Flanged Base U-Bar Interchangeable with 207 Series</p> 	<p>2002-UR207 Flanged Base U-Bar Interchangeable with 207 Series, DE-STA-CO® Toggle Lock Plus</p> 			

Note: Clamps shown with included accessories.

ⓘ This item is available upon request

Series 2002 Technical Information

Model	Max. Holding Capacity	Clamp Bar Opening (+10°)	Handle Opening (+10°)	Weight	Accessories (Supplied)				
					Bolt Retainer	Spindle Assembly	Flanged Washers		
2002-U	2700 N [600 lbf]	75°	66°	0,22kg [0.48lb]	--	215208-M	215105		
2002-U-LS-BLK ⓘ					--	--	215105-BLK		
2002-S					2002115-E	--	--		
2002-UB					--	215208-M	215105		
2002-UB-LS-BLK ⓘ					--	--	215105-BLK		
2002-SB					2002115-E	--	--		
2002-UR				--	215208-M	215105			
2002-SR ⓘ				2002115-E	--	--			
2002-UBR				--	215208-M	215105			
2002-SBR ⓘ				2002115-E	--	--			
2002-U207				90°	72°	0,26kg [0.57lb]	--	215208-M	215105
2002-UR207				75°	57°				

ⓘ This item is available upon request

Series 2002 Holding Capacities

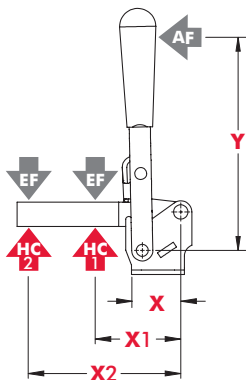

Model	X	X1	X2	Y	±HC1	±HC2	±EF(X1):AF	±EF(X2):AF
2002-()	[1.12] 28,5	[1.45] 37	[2.64] 67	[3.66] 93	[600 lbf] 2700N	[295 lbf] 1310N	11:1	5:1

Dimensions shown "mm [inch]" ± HC = Holding Capacity, EF = Exerting Force, AF = Applied Force
Refer to page 14.4 for additional information.

Series 2002 Standard Clamp Dimensions
-U/-S/-UB/-SB/-UR/-SR/-UBR/-SBR

2002-U
Flanged Base
U-Bar

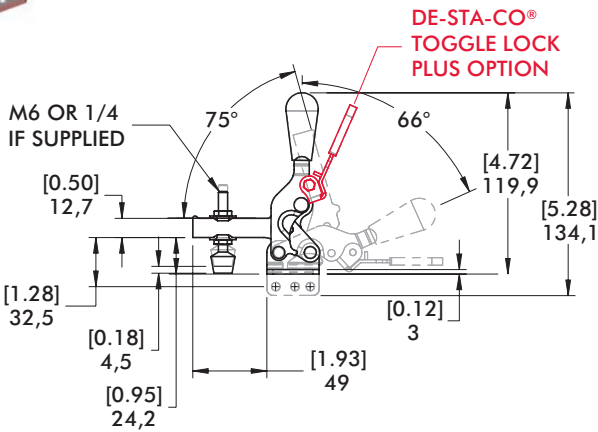
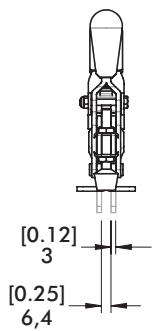
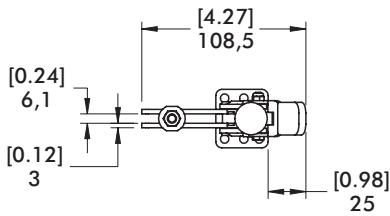

DE-STA-CO®
TOGGLE LOCK
PLUS OPTION

2002-SB
Straight Base
Solid Bar

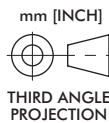
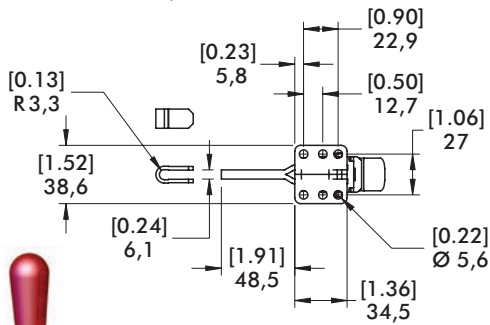

2002-U207/2002-UR207
with interchangeable Series 207
Mounting Pattern

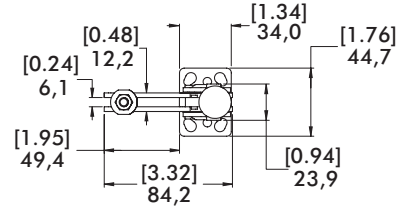

DE-STA-CO®
TOGGLE LOCK
PLUS OPTION

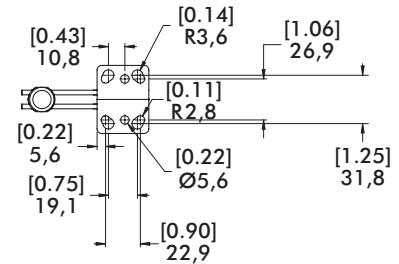
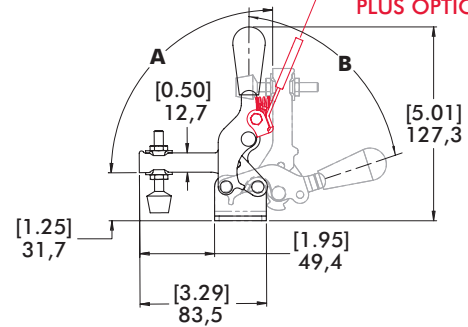

Model	A	B
2002-U-207	90°	72°
2002-UR207	75°	57°

DE-STA-CO offers custom clamping solutions

When an off-the-shelf product can't handle it - we can!

With years of experience using our expertise to develop custom solutions for unique applications, DE-STA-CO helps you save time and resources, allowing you to focus on your core business and gain a competitive advantage in the marketplace.

- **Proven quality** from the experts
- **Reduce risk** by using our experienced engineers
- **Easy reordering** with unique part numbers
- **Simplify** your supply chain
- **Three levels of customization** from simple alterations to complex custom products

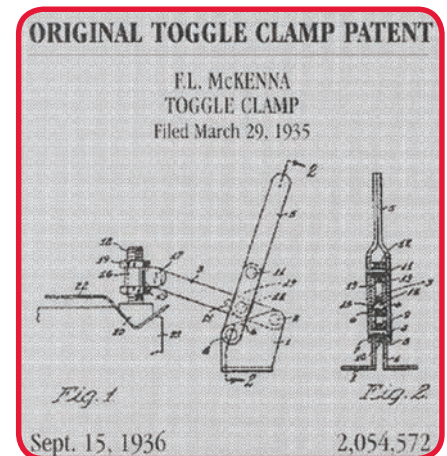

Model 330

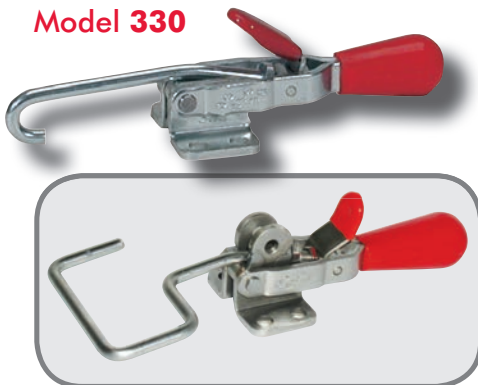

330-201 Stainless steel clamp with special hook and locking tab

Model 604



604-229 Stainless steel straight line clamp used in chemical machining process

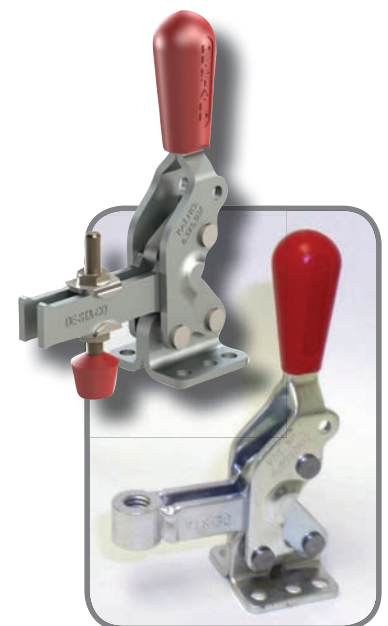

2002-200 with bar cut and bolt retainer welded on

Contact us today to get started on your custom application: clamps@destaco.com

(* All inquiries subject to minimum order

Series 2007 Product Overview

Features:

- Large hand clearance for improved safety
- Bolt pattern interchangeable with 207 Series
- Over two times the holding capacity of 207 Series
- Hardened bushings at key pivot points
- Near vertical clamping contact

Applications:

- Checking fixtures
- Assembly & test
- Light machining
- Woodworking

Also Available:

See page 7.1 for accessories
Accepts M8 or 5/16 spindle accessories

Covered under one or more U.S./International Patents

2007-U
Flanged Base
U-Bar



2007-U-LS-BLK ⓘ
Blackout Series
Flanged Base
U-Bar



2007-S
Flanged Base
Solid Bar



2007-UB
Straight Base
U-Bar

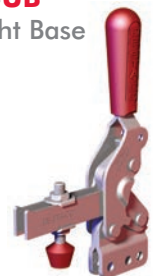

2007-UB-LS-BLK ⓘ
Blackout Series
Straight Base
U-Bar



2007-SB
Straight Base
Solid Bar



2007-UR
Flanged Base
U-Bar
with
DE-STA-CO®
Toggle Lock
Plus



2007-SR ⓘ
Flanged Base
Solid Bar
with
DE-STA-CO®
Toggle Lock
Plus



2007-UBR
Straight Base
U-Bar
with
DE-STA-CO®
Toggle Lock
Plus



2007-SBR ⓘ
Straight Base
Solid Bar
with
DE-STA-CO®
Toggle Lock
Plus



Note: Clamps shown with included accessories.

Series 2007 Technical Information

Model	Max. Holding Capacity	Clamp Bar Opening (+10°)	Handle Opening (+10°)	Weight	Accessories (Supplied)		
					Bolt Retainer	Spindle Assembly	Flanged Washers
2007-U	4450 N [1000 lbf]	76°	64°	0,54kg [1.20lbs]	--	2007208-M	507107
2007-U-LS-BLK ⓘ					--	--	507107-BLK
2007-S					2007115-E	--	--
2007-UB					--	2007208-M	507107
2007-UB-LS-BLK ⓘ					--	--	507107-BLK
2007-SB					2007115-E	--	--
2007-UR					--	2007208-M	507107
2007-SR ⓘ					2007115-E	--	--
2007-UBR					--	2007208-M	507107
2007-SBR ⓘ					2007115-E	--	--

ⓘ This item is available upon request



Series 2007 Holding Capacities

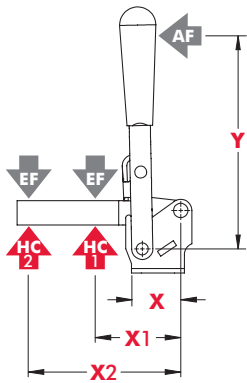

Model	X	X1	X2	Y	±HC1	±HC2	±EF(X1):AF	±EF(X2):AF
2007-()	[1.59] 40,5	[1.95] 49,5	[3.92] 99,5	[5.16] 131	[1000lbf.] 4450N	[470lbf.] 2090N	10:1	5.3:1

Dimensions shown "mm [inch]" † HC = Holding Capacity, EF = Exerting Force, AF = Applied Force
Refer to page 14.4 for additional information.

Series 2007 Standard Clamp Dimensions -U/-S/-UB/-SB/-UR/-SR/-UBR/-SBR

2007-U
Flanged Base
U-Bar

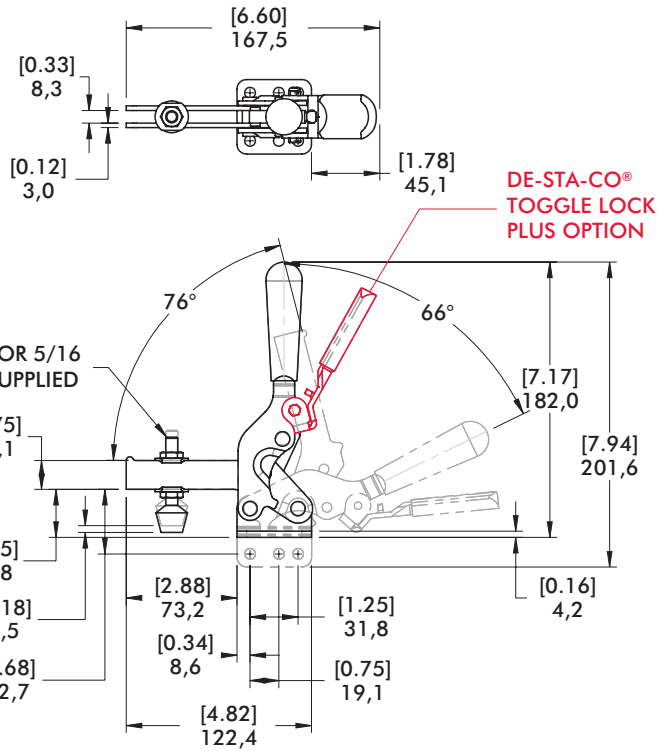
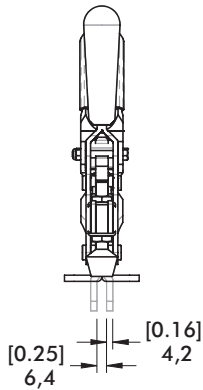

2007-SB
Straight Base
Solid Bar

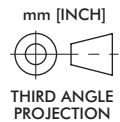
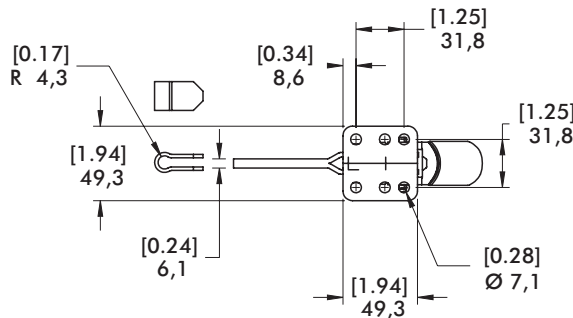

Series 2010 Product Overview

Features:

- Large hand clearance for improved safety
- Bolt pattern interchangeable with 210 Series
- Over two times the holding capacity of 210 Series
- Hardened bushings at key pivot points
- Near vertical clamping contact

Applications:

- Checking fixtures
- Assembly & test
- Light machining
- Woodworking

Also Available:

See page 7.1 for accessories

Accepts M10 or 3/8 spindle accessories

Covered under one or more U.S./International Patents

2010-U
Flanged Base
U-Bar



2010-S
Flanged Base
Solid Bar



2010-UB
Straight Base
U-Bar



2010-SB
Straight Base
Solid Bar



2010-UR
Flanged Base
U-Bar
with DE-STA-CO®
Toggle Lock Plus



2010-SR ⓘ
Flanged Base
Solid Bar
with DE-STA-CO®
Toggle Lock Plus



2010-UBR
Straight Base
U-Bar
with DE-STA-CO®
Toggle Lock Plus



2010-SBR ⓘ
Straight Base
Solid Bar
with DE-STA-CO®
Toggle Lock Plus



Note:
Clamps shown with included accessories.

Series 2010 Technical Information

Model	Max. Holding Capacity	Clamp Bar Opening (+10°)	Handle Opening (+10°)	Weight	Accessories (Supplied)		
					Bolt Retainer	Spindle Assembly	Flanged Washers
2010-U	6230 N [1400 lbf]	78°	66°	1,16kg [2.56lbs]	---	240208-M	235106
2010-S					2010115-E	---	
2010-UB					---	240208-M	235106
2010-SB					2010115-E	---	
2010-UR					---	240208-M	235106
2010-SR ⓘ					2010115-E	---	
2010-UBR					---	240208-M	235106
2010-SBR ⓘ					2010115-E	---	

ⓘ This item is available upon request



Series 2010 Holding Capacities

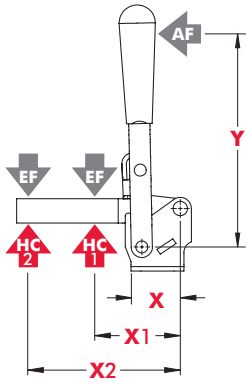

Model	X	X1	X2	Y	±HC1	±HC2	±EF(X1):AF	±EF(X2):AF
2010-()	[2.04] 51,8	[2.44] 62	[4.88] 124	[7.00] 178	[1400lbf.] 6230N	[720lbf.] 3200N	13:1	6:1

Dimensions shown "mm [inch]" ± HC = Holding Capacity, EF = Exerting Force, AF = Applied Force
Refer to page 14.4 for additional information.

Series 2010 Standard Clamp Dimensions

-U/-S/-UB/-SB/-UR/-SR/-UBR/-SBR

2010-U
Flanged Base
U-Bar

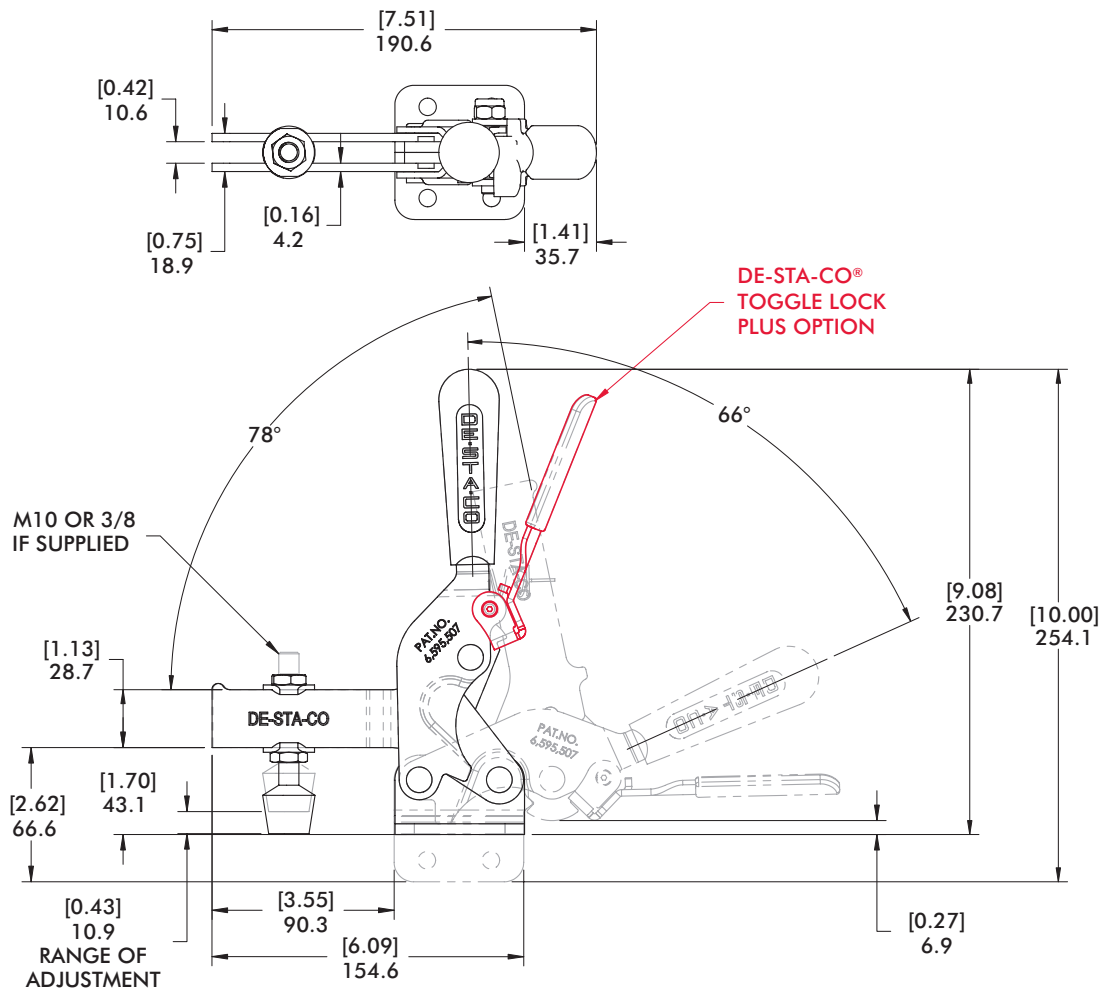

2010-SB
Straight Base
Solid Bar

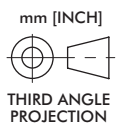
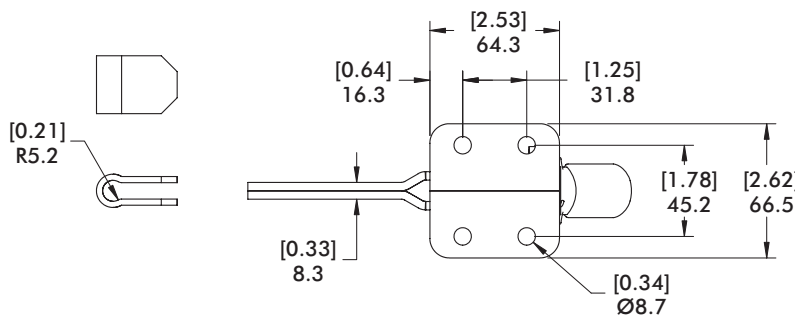

Series 201 Product Overview

Features:

- Smallest series in the Vertical Handle series
- Stainless steel version available

Applications:

- Checking fixtures
- Assembly & test
- Woodworking

Also Available:

See page 7.1 for accessories

812-U Pneumatic Toggle Clamp
(See page 9.3)

201-U
Flanged Base
U-Bar

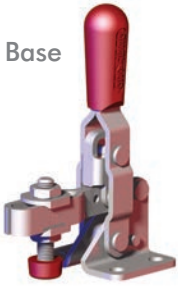

201-UB
Straight Base



201-TU
Straight
Base, U-Bar,
T-Handle



201-USS
Flanged Base
U-Bar, Stainless
Steel



Note:
Clamps shown with included accessories.

Series 201 Technical Information

Model	Max. Holding Capacity	Clamp Bar Opening (+10°)	Handle Opening (+10°)	Weight	Accessories (Supplied)	
					Spindle Assembly	Flanged Washers
201-U	440 N [100 lbf]	100°	55°	0,70kg [0.15lbs]	305208-M	102111
201-UB						
201-TU	560 N [125 lbf]				201943-M	102911
201-USS						

Series 201 Holding Capacities

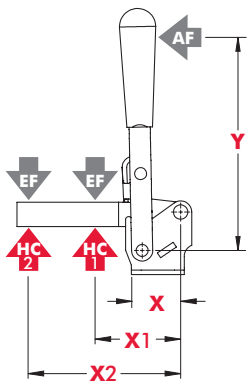

Model	X	X1	X2	Y	±HC1	±HC2	±EF(X1):AF	±EF(X2):AF
U/UB				[2.25] 57	[100lbf.]	[55lbf.]	9:1	6:1
TU	[0.87] 22	[1.06] 27	[1.75] 44,5	[1.38] 35	440N	245N	8.4:1	4:4:1
USS				[2.25] 57	[125lbf.] 560N	[60lbf.] 270N	9:1	6:1

Dimensions shown "mm [inch]" ± HC = Holding Capacity, EF = Exerting Force, AF = Applied Force
Refer to page 14.4 for additional information.

Series 201 Standard Clamp Dimensions -U/-UB/-TU/-USS

201-U
Flanged Base
U-Bar

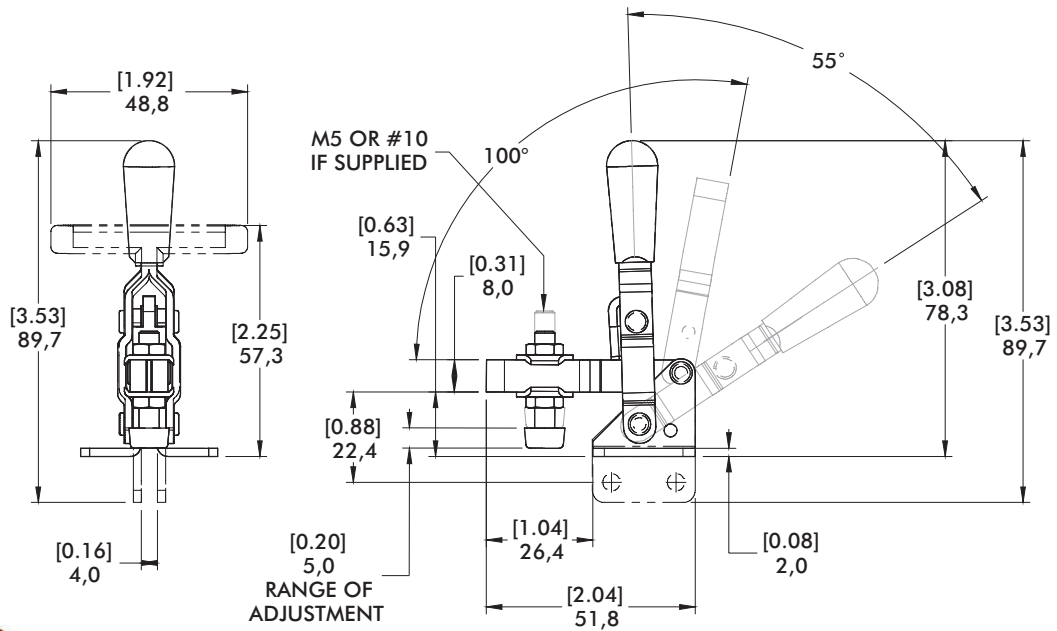
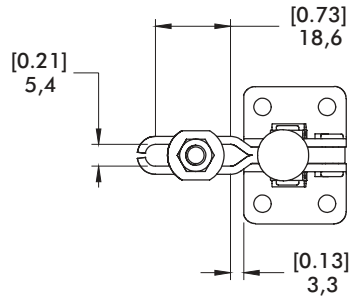
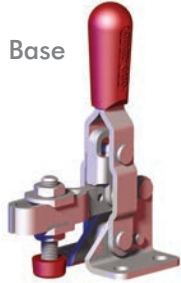

201-UB
Straight Base

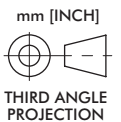
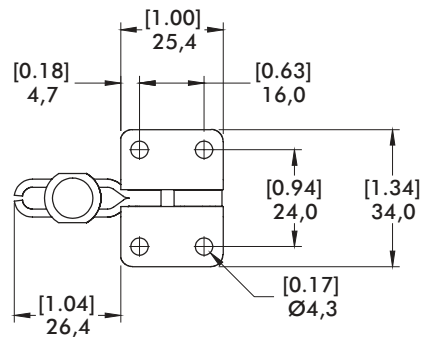

Series 202 Product Overview

Features:

- Two bar styles available
- Low profile T-Handle version available
- Available in stainless steel
- Accommodates M6 or 1/4" spindle accessories
- BLK models feature a black, non-reflective finish

Applications:

- Checking fixtures
- Assembly & test
- Light machining
- Woodworking

Also Available:

See page 7.1 for accessories
 802-U Pneumatic Toggle Clamp
 (See page 9.5)

202-U
Flanged Base
U-Bar



202-UL
Flanged Base
Long U-Bar

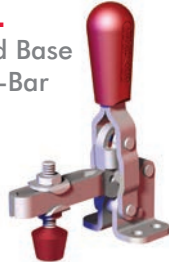

202-USS
Flanged Base
U-bar, Stain-
less Steel

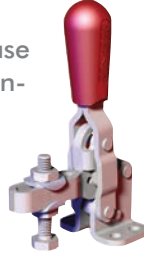

202
Flange Base
Solid Bar



202-SS
Flanged Base
Solid Bar
Stainless Steel



202-UB
Straight Base
U-bar



202-B
Straight Base
Solid Bar



202-TU
Flanged Base
U-bar,
T-Handle

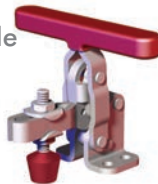

202-T
Flanged Base
Solid Bar
T-Handle



202-U-L ⓘ
Flanged Base
Open U-Bar



202-U-L-BLK ⓘ
Blackout Series
Flanged Base
Open U-Bar



202-UB-L ⓘ
Straight Base
Open U-Bar



202-UB-L-BLK ⓘ
Blackout Series
Straight Base
Open U-Bar



202305
Flanged Grip.
Provides added safety
and protection. Fits all
202 Series (except
T-Handle) clamps.
Order separately.



Note: Clamps shown with included accessories.

ⓘ This item is available upon request



Series 202 Technical Information

Model	Max. Holding Capacity	Clamp Bar Opening (+10°)	Handle Opening (+10°)	Weight	Accessories (Supplied)	
					Spindle Assembly	Flanged Washers
202-U	890 N [200 lbf]	105°	65°	0,16kg [0.35lbs]	202208-M	215105
202-UL					202943-M	215905
202-USS	1110 N [250 lbf]			202208-M	---	
202				205943-M	---	
202-SS	890 N [200 lbf]			0,15kg [0.33lbs]	202208-M	215105
202-UB				0,16kg [0.35lbs]		
202-B	0,15kg [0.33lbs]					
202-TU	890 N [200 lbf]			0,17kg [0.38lbs]	---	---
202-T				0,16kg [0.35lbs]		
202-U-L ⓘ						
202-U-L-BLK ⓘ						
202-UB-L ⓘ						
202-UB-L-BLK ⓘ						

ⓘ This item is available upon request

Series 202 Holding Capacities

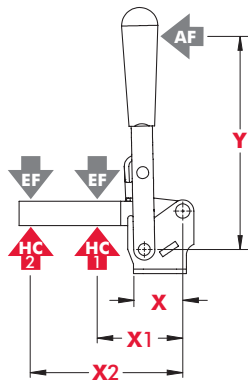

Model	X	X1	X2	Y	±HC1	±HC2	±EF(X1):AF	±EF(X2):AF	
202-U	[0.79] 20	[1.25] 32	[2.25] 57	[3.42] 87	[200 lbf] 890N	[140 lbf] 625N	10:1	5:1	
202-UL			[2.88] 73	[2.25] 57	[3.00] 76	[250 lbf] 1110N		[150 lbf] 670N	4:1
202-USS			[2.25] 57	[3.42] 87	---	[200 lbf] 890N		[170 lbf] 760N	5:1
202		---	[1.88] 48	[3.42] 87	---	[250 lbf] 1110N	---	8:1	
202-SS		---	[3.00] 76	---	---	[200 lbf] 890N	[140 lbf] 625N	10:1	5:1
202-UB		[1.25] 32	[2.25] 57	[3.42] 87	---	[200 lbf] 890N	[140 lbf] 625N	---	8:1
202-B		---	[1.88] 48	[3.42] 87	---	[200 lbf] 890N	[140 lbf] 625N	11:1	7:1
202-TU		[1.25] 32	[2.25] 57	[2.13] 54	---	[200 lbf] 890N	[140 lbf] 625N	---	6:1
202-T		---	[1.88] 48	---	---	[200 lbf] 890N	[140 lbf] 625N	---	---
202-U-L ⓘ		---	---	---	---	---	---	---	---
202-U-L-BLK ⓘ		[1.25] 32	[2.25] 57	[3.42] 87	---	[200 lbf] 890N	[140 lbf] 625N	10:1	5:1
202-UB-L ⓘ		---	---	---	---	---	---	---	---
202-UB-L-BLK ⓘ	---	---	---	---	---	---	---	---	

Dimensions shown "mm [inch]" ± HC = Holding Capacity, EF = Exerting Force, AF = Applied Force

ⓘ This item is available upon request

Series 202 Standard Clamp Dimensions
202/-U/-UL/-USS/-SS/-UB/-B/-TU/-T

202-U
Flanged Base
U-Bar

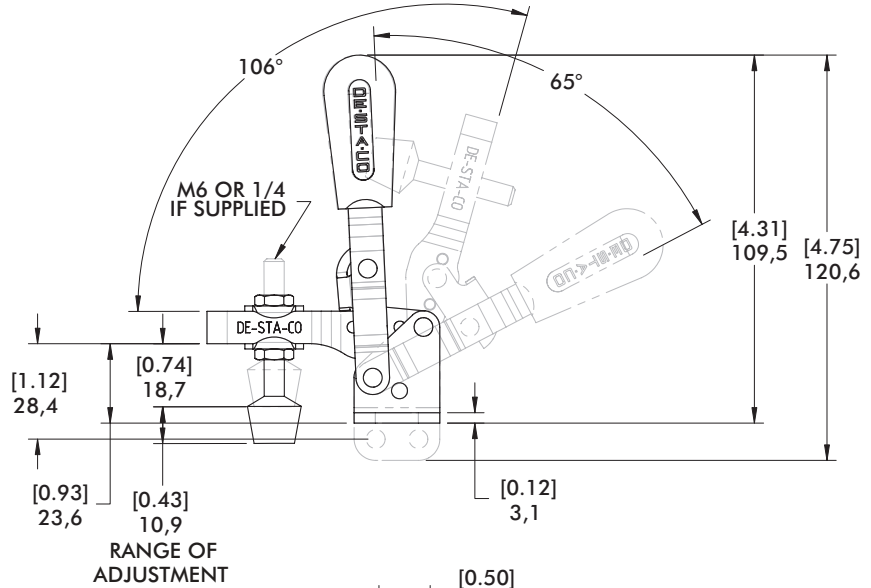
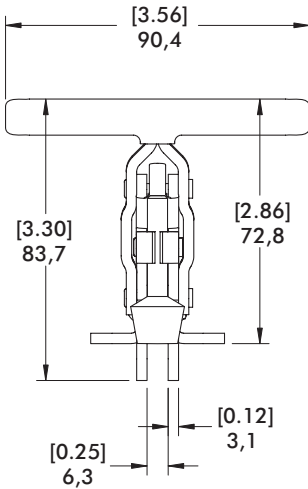
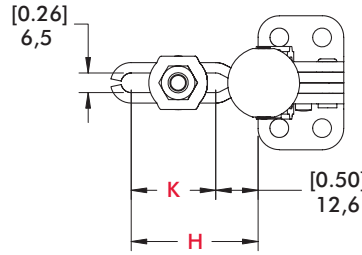

Series 202 Open Bar



See page (7.7) for complete offering of open bar accessories

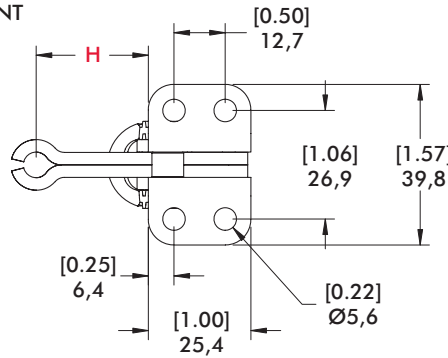

mm [INCH]
THIRD ANGLE PROJECTION

Flanged Base

Model

- 202-U-L ⓘ
- 202-U-L-BLK ⓘ

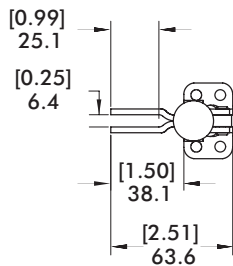

Straight Base

Model

- 202-UB-L ⓘ
- 202-UB-L-BLK ⓘ



Bar Style	Clamp Models	H	K
	202-U/202-UB/ 202-USS/202-TU	[1.73] 44,1	[0.98] 25
	202-UL ⓘ	[2.29] 58,1	[1.51] 38,4
	202/202-B/ 202-T/202-SS	[1.08] 27,4	---
	202-U-L ⓘ/ 202-UB-L ⓘ	[1.50] 38,1	---

ⓘ This item is available upon request

Application Areas

Clamping during the assembling, drilling, testing, gluing, locking of covers and much more. The vertical clamp is the most frequently used product whenever clamping products are to be integrated with a manual fixture.

The essential product features

- In the clamping position, the handle is vertical
- Vertical clamps open at an angle between 75° and 215°
- Vertical clamps are offered with U-shaped or heavy-duty solid clamping bars
- Vertical clamps have a straight or flanged base.
The heavy-duty vertical clamps possess a base that can be welded on without a hole pattern

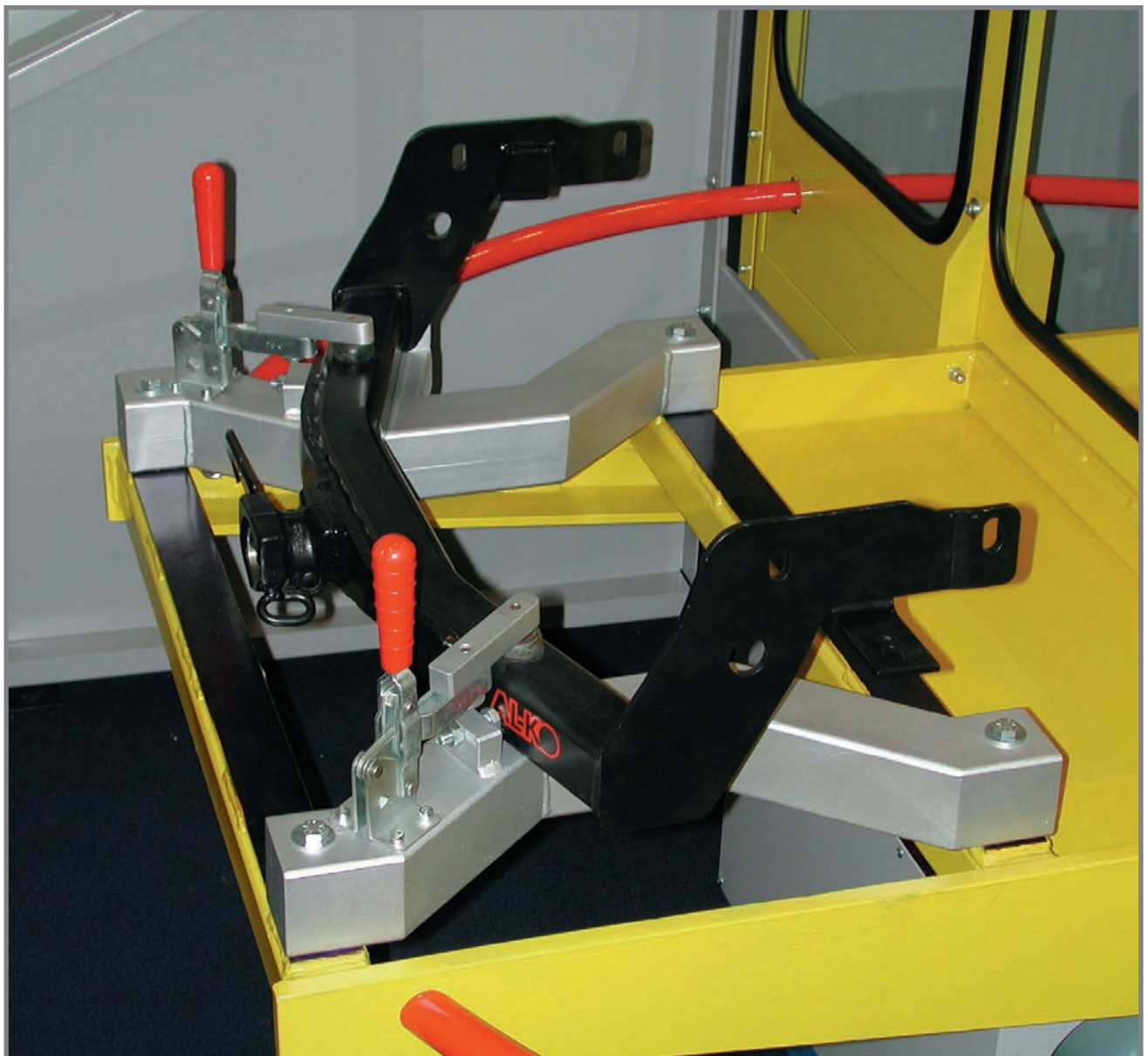

Series 207 Product Overview

Features:

- Largest selection of arm and mounting options
- Low profile T-Handle version available
- Available in stainless steel
- BLK models feature a black, non-reflective finish

Applications:

- Checking fixtures
- Assembly & test
- Light machining
- Woodworking

Also Available:

See page 7.1 for accessories

807-U Pneumatic toggle clamp
(See page 9.8)

807-S Pneumatic toggle clamp
(See page 9.8)

Accepts M8 or 5/16 spindle accessories

207-U
Flanged Base
U-Bar



207-UL
Flanged Base
Long U-Bar

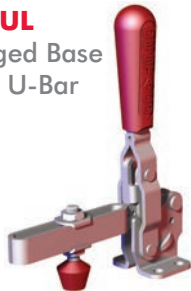

207-USS
Stainless
Flanged Base
U-Bar



207-S
Flanged Base
Solid Bar



207-L
Flanged Base
Long Solid Bar



207-TU
Flanged Base
T-Handle
U-Bar



207-TUL
Flanged Base
T-Handle
Long U-Bar



207-UR
Flanged Base
U-Bar
with
DE-STA-CO®
Toggle Lock
Plus



207-LR
Flanged Base
Long Solid Bar
with
DE-STA-CO®
Toggle Lock
Plus



207-UB
Straight Base
U-Bar



207-ULB
Straight Base
Long U-Bar



207-SB
Straight Base
Solid Bar



207-LB
Straight Base
Long Solid
Bar



207-LBR ⓘ
Straight Base
Long Solid
Bar with
DE-STA-CO®
Toggle Lock
Plus



207-UF ⓘ
U-Bar
Dual Mount



207-SF ⓘ
Solid Bar
Dual Mount



207-U-L ⓘ
Flange Base
Open Bar



207-U-L-BLK
Blackout Series
Flanged Base
Open U-Bar



207-UB-L ⓘ
Straight Base
Open Bar



207-UB-L-BLK
Blackout Series
Straight Base
Open U-Bar



207305

Flanged Grip. Provides added safety and protection. Fits all 207 Series (except T-Handle) clamps. Order separately.



Note: Clamps shown with included accessories.

ⓘ This item is available upon request

Series 207 Technical Information

Model	Max. Holding Capacity	Clamp Bar Opening (+10°)	Handle Opening (+10°)	Weight	Accessories (Supplied)						
					Bolt Retainer	Spindle Assembly	Flanged Washers				
207-U	1670 N [375 lbf]	99°	57°	0,30kg [0.67lb]	---	225208-M	507107				
207-UR				0,45kg [1.00lb]							
207-UL				0,30kg [.67lb]							
207-USS	2000 N [450 lbf]			0,32kg [0.70lb]	---	207943-M	507907				
207-S	2220 N [500 lbf]			99°	57°	0,31kg [0.69lb]	207105	---	---		
207-L						0,34kg [0.74lb]					
207-LR						0,45kg [1.00lb]					
207-UB	1670 N [375 lbf]			99°	57°	0,33kg [0.72lb]	---	225208-M	507107		
207-ULB						0,31kg [0.69lb]					
207-SB						0,34kg [0.75lb]					
207-LB	2220 N [500 lbf]					0,45kg [1.00lb]	207105	---	---		
207-LBR ⓘ	1670 N [375 lbf]					99°	57°	0,33kg [0.72lb]	---	---	507107
207-TU		0,43kg [0.94lb]									
207-TUL		0,38kg [0.84lb]									
207-UF ⓘ	1670 N [375 lbf]	96°	56°					0,43kg [0.94lb]	---	225208-M	507107
207-SF ⓘ	2220 N [500 lbf]	90°	57°					0,38kg [0.84lb]	207105	---	---
207-U-L ⓘ	1670 N [375 lbf]	99°	57°					0,38kg [0.84lb]	---	---	---
207-U-L-BLK ⓘ											
207-UB-L ⓘ											
207-UB-L-BLK ⓘ											

ⓘ This item is available upon request

Series 207 Holding Capacities

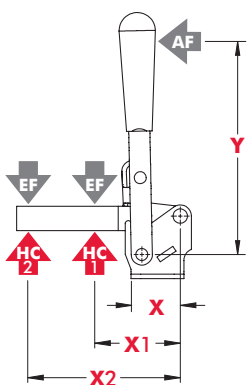

Model	X	X1	X2	Y	±HC1	±HC2	±EF(X1):AF	±EF(X2):AF	
U/UB/UR	[1.28] 32,6	[2.00] 50,8	[3.75] 95,3	[4.90] 124,5	[375 lbf] 1670N	[225 lbf] 1000N	12:1	6:1	
UL/ULB		[3.88] 98,5	[5.00] 127		[3.75] 95,3	[150 lbf] 670N	[240 lbf] 1070N	7:1	4:1
USS		[2.00] 50,8	[3.75] 95,3			[450 lbf] 2000N	[350 lbf] 1560N	10:1	7:1
S/SB		[2.88] 73,0	[5.00] 127	[3.66] 9	[500 lbf] 2220N	[375 lbf] 1670N	6:1	4:1	
L/LR LB/LBR		[2.88] 73,0	[5.00] 127		[150 lbf] 670N	[225 lbf] 1000N			4:1
TU		[2.00] 50,8	[3.75] 95,3	[4.90] 124,5	[375 lbf] 1670N	[225 lbf] 1000N	12:1	6:1	
TUL		[3.88] 98,5	[5.00] 127	[3.75] 95,3	[375 lbf] 1670N	[225 lbf] 1000N	12:1	6:1	
U-L		[2.00] 50,8	[3.75] 95,3	[4.90] 124,5	[375 lbf] 1670N	[225 lbf] 1000N	12:1	6:1	
UB-L		[2.00] 50,8	[3.75] 95,3	[4.90] 124,5	[375 lbf] 1670N	[225 lbf] 1000N	12:1	6:1	

Dimensions shown "mm [inch]" ± HC = Holding Capacity, EF = Exerting Force, AF = Applied Force

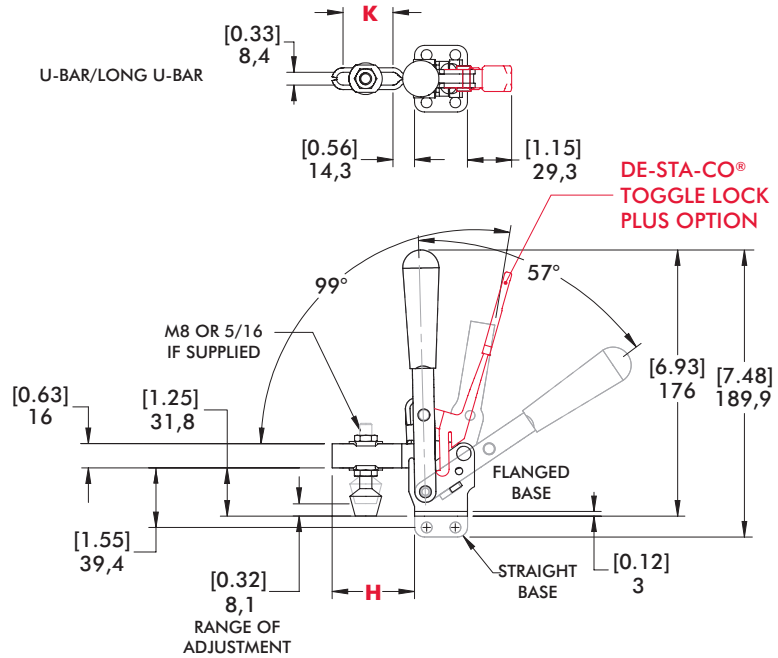
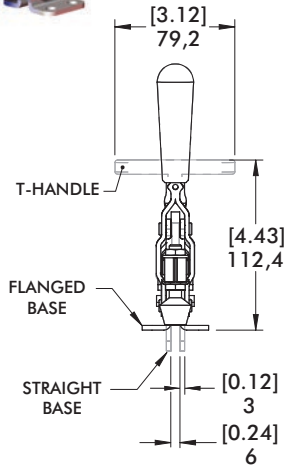

Series 207 Standard Clamp Dimensions
 -U/-UL/-S/-L/-TU/-TUL/-UR/-LR/-UB/-ULB/-SB/-LB/-LBR

207-U
 Flanged Base
 U-Bar

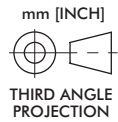
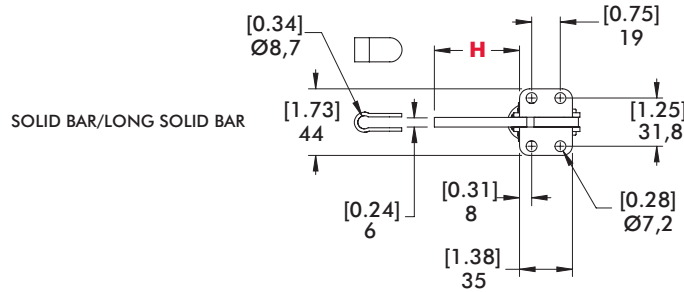

207-SB
 Straight Base
 Solid Bar

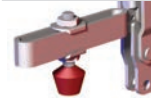

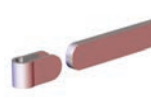
Bar Style	Clamp Models	H	K
	207-U/207-UR/207-TU/207-UB	[2.14] 54,4	[1.30] 33
	207-UL/207-ULB/207-TUL	[3.84] 97,6	[2.94] 74,6
	207-S/207-SB	[2.21] 56,2	---
	207-L/207-LR/207-LB/207-LBR ⓘ	[3.48] 88,4	---

ⓘ This item is available upon request

Series 207 Standard Clamp Dimensions - Dual Mount

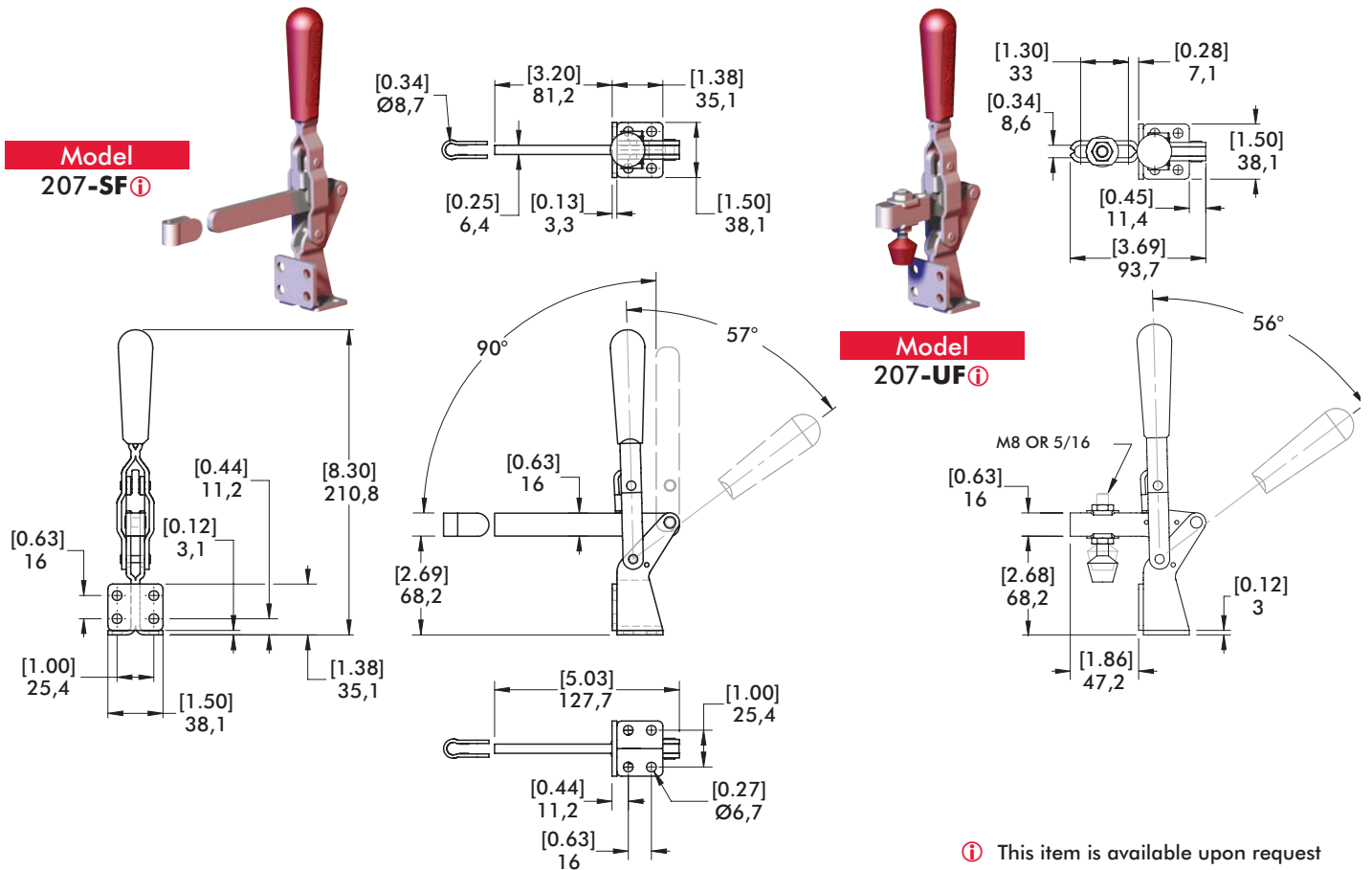

Series 207 Open Bar

See page 7.7 for Complete offering of Open bar accessories

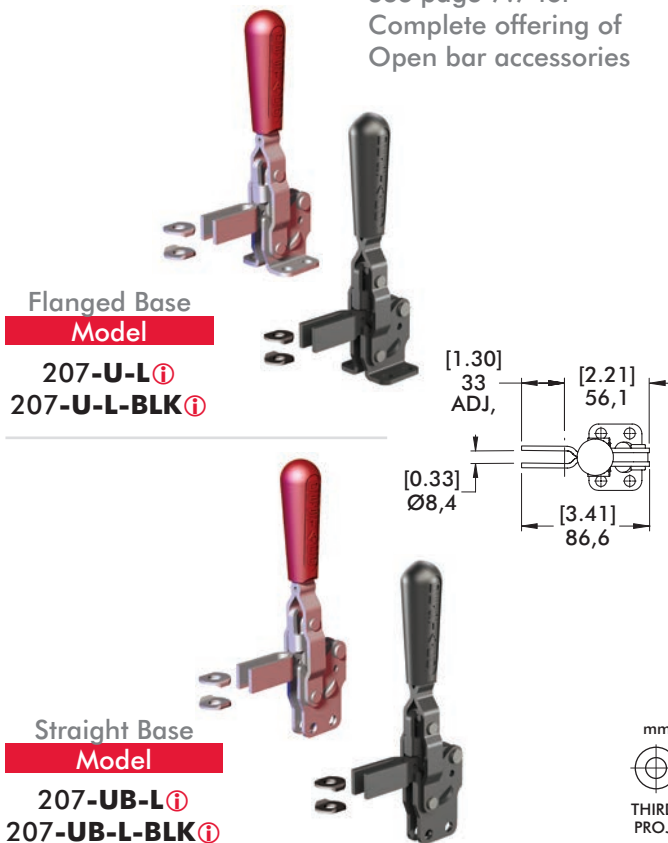

207-USS Stainless Steel

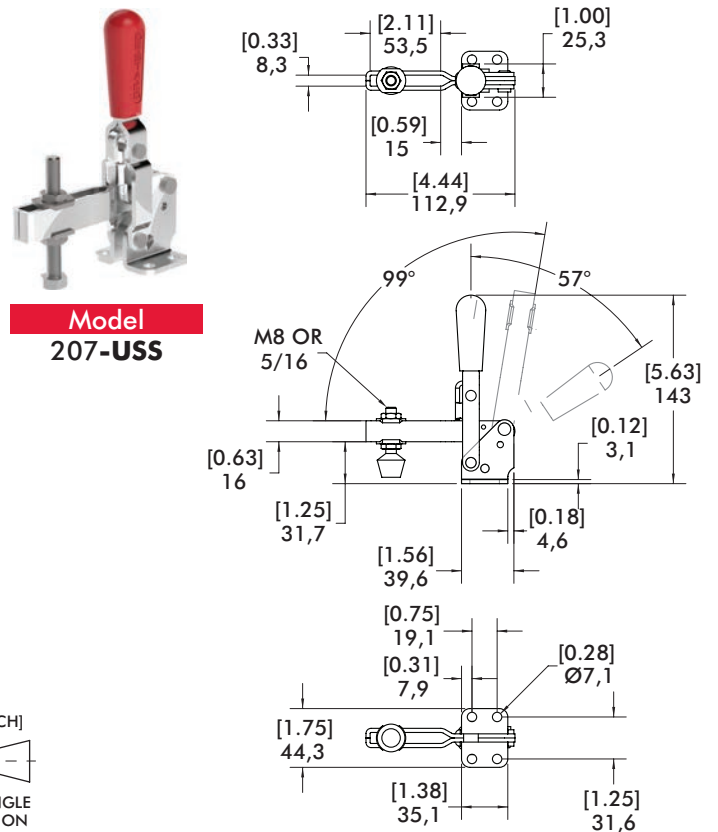

Series 210 Product Overview

Features:

- DE-STA-CO® Toggle Lock Plus versions available
- Available in stainless steel
- Accomodates M10 or 3/8 spindle accessories

Applications:

- Assembly & test
- Light machining
- Light welding

Also Available:

See page 7.1 for accessories
 810-U Pneumatic Toggle Clamp
 (See page 9.9)
 810-S Pneumatic Toggle Clamp
 (See page 9.9)

210-U
Flanged Base
U-Bar



210-USS
Flanged Base
U-bar, Stainless
Steel



210-S
Flanged Base
Solid Bar

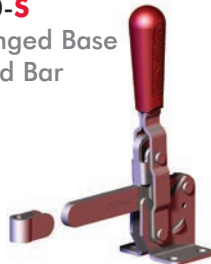

210-UB
Straight Base
U-bar



210-SB
Straight Base,
Solid Bar



210-UR
Flanged Base
U Bar
with
DE-STA-CO®
Toggle Lock
Plus



210-SR
Flanged Base
Solid Bar
with
DE-STA-CO®
Toggle Lock
Plus



210-TU
Flanged Base
U Bar,
T-Handle



Note: Clamps shown with included accessories.

Series 210 Technical Information

Model	Max. Holding Capacity	Clamp Bar Opening (+10°)	Handle Opening (+10°)	Weight	Accessories (Supplied)		
					Bolt Retainer	Spindle Assembly	Flanged Washers
210-U	2670 N [600 lbf]	103°	58°	0,59kg [1.29lbs]	---	240208-M	235106
210-USS	3340 N [750 lbf]				---	237943-M	235906
210-S					210114	237943-M	---
210-UB	2670 N [600 lbf]				---	240208-M	235106
210-SB	3340 N [750 lbf]			210114	---	---	
210-UR	2670 N [600 lbf]			0,73kg [1.60lbs]	---	240208-M	235106
210-SR	3340 N [750 lbf]				210114	---	---
210-TU	2670 N [600 lbf]				---	---	235106

Series 210 Holding Capacities

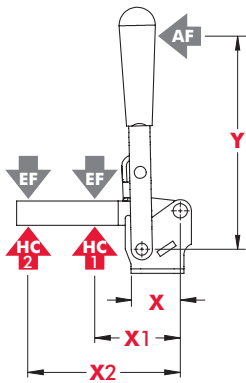

Model	X	X1	X2	Y	±HC1	±HC2	±EF(X1):AF	EF(X2):AF
U/UB/UR	[1.54] 39	[2.38] 60,5	[4.88] 124	[6.75] 171,5	[600lbf.] 2670N	[290lbf.] 1290N	14:1	7:1
USS		[750lbf.] 3340N	[360lbf.] 1600N					
S/SR/SB		[3.62] 92,0	[5.25] 133	[4.50] 114,5	[750lbf.] 3340N	[500lbf.] 2220N	11:1	9:1
TU		[2.38] 60,5	[4.88] 124	[600lbf.] 2670N	[290lbf.] 1290N			

Dimensions shown "mm [inch]" ± HC = Holding Capacity, EF = Exerting Force, AF = Applied Force
Refer to page 14.4 for additional information.

Series 210 Standard Clamp Dimensions -U/-USS/-S/-UB/-SB/-UR/-SR/-TU

210-U
Flanged Base
U-Bar

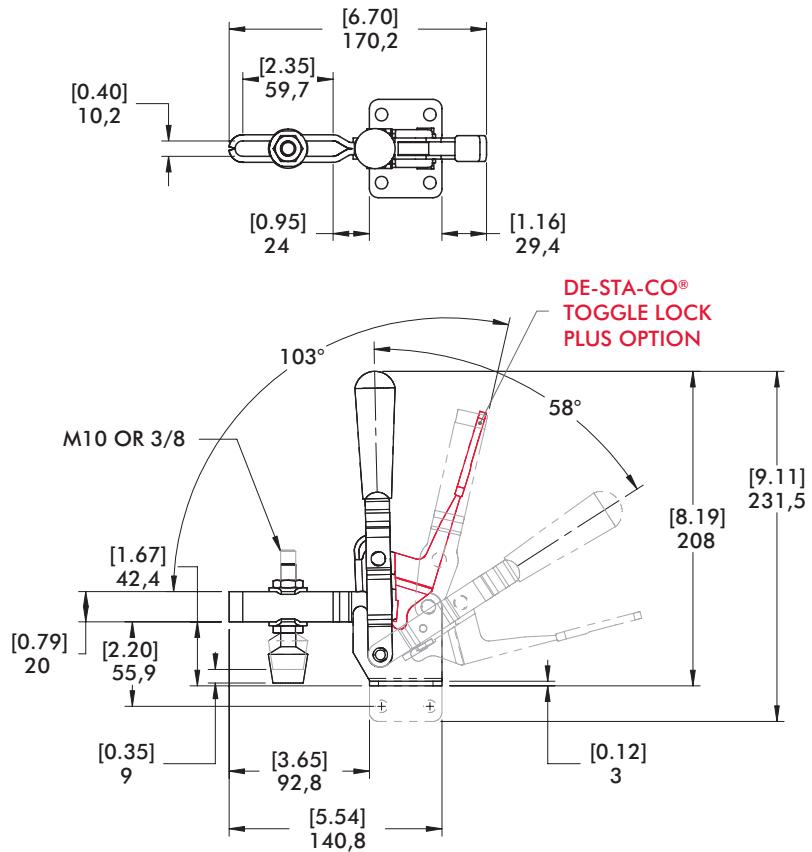
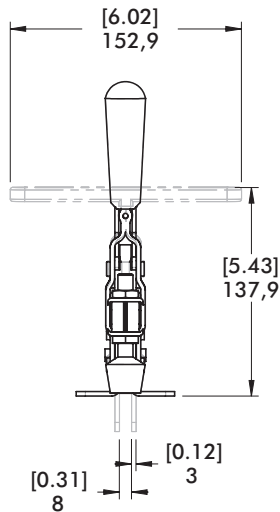

210-SR
Flanged Base
Solid Bar
with
DE-STA-CO®
Toggle Lock
Plus

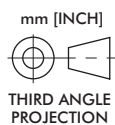
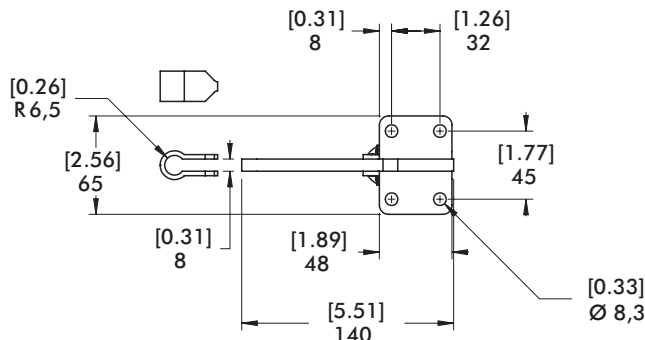

Series 247, 267 Product Overview

Features:

- Hardened steel bushings
- Large bar guides for greater lateral stability on Model 247
- Series 247 accomodates M12 or 1/2 spindle accessory
- Series 267 accomodates M16 or 5/8 spindle accessory

Applications:

- Assembly & test
- Light machining
- Welding

Also Available:

See page 7.1 for accessories
 847-U Pneumatic Toggle Clamp (See page 9.15)
 847-S Pneumatic Toggle Clamp (See page 9.15)

247-U
Flanged Base
U-Bar



247-S
Flanged Base
Solid Bar



247-UB ⓘ
Straight Base
U-Bar



267-U
Flanged Base
U-Bar

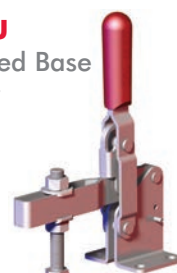

267-S ⓘ
Flanged Base
Solid Bar



Note:
Clamps shown with included accessories.

Series 247, 267 Technical Information

Model	Max. Holding Capacity	Clamp Bar Opening (+10°)	Handle Opening (+10°)	Weight	Accessories (Supplied)		
					Bolt Retainer	Spindle Assembly	Flanged Washers
247-U	4400 N [1000 lbf]	120°	67°	1,07kg [2.36lbs]	---	247208-M	247109
247-S				1,08kg [2.36lbs]	247110	---	---
247-UB ⓘ				1,07kg [2.36lbs]	---	247208-M	247109
267-U	5340 N [1200 lbf]	140°	72°	2,18kg [4.80lbs]	---	267203-M	267102
267-S ⓘ				1,98kg [4.36lbs]	110122	---	---

ⓘ This item is available upon request

Series 247 Holding Capacities

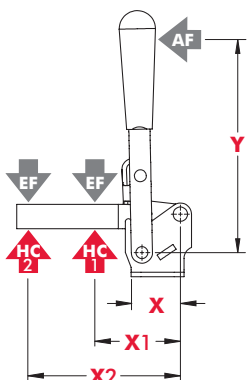

Model	X	X1	X2	Y	‡HC1	‡HC2	‡EF(X1):AF	‡EF(X2):AF
247-U/ 247-UB ⓘ	[1.69] 43	[3.00] 76,2	[6.13] 155,7	[6.71] 170,5	[1000lbf.] 4450N	[480lbf.] 2140N	12:1	6:1
247-S		[4.56] 115,8	[7.00] 177,8			[650lbf.] 2900N	10:1	5:1
267-U	[2.50] 63,5	[4.00] 101,6	[8.00] 203,2	[9.25] 235	[1200lbf.] 5340N	[600lbf.] 2670N	18:1	8:1
267-S ⓘ		[6.00] 152,4	[8.75] 222,3			[820lbf.] 3650N	12:1	

Dimensions shown "mm [inch]" ‡ HC = Holding Capacity, EF = Exerting Force, AF = Applied Force
 Refer to page 14.4 for additional information. ⓘ This item is available upon request

Series 247 Standard Clamp Dimensions -U/-S/-UB

247-U
Flanged Base
U-Bar

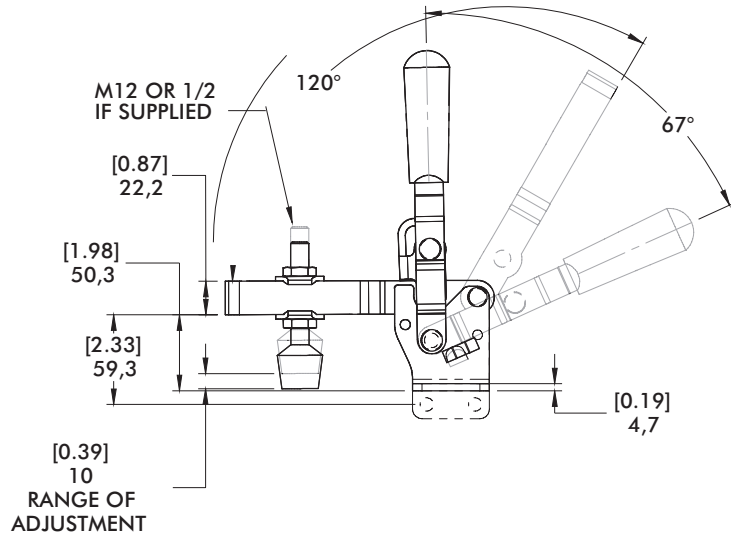
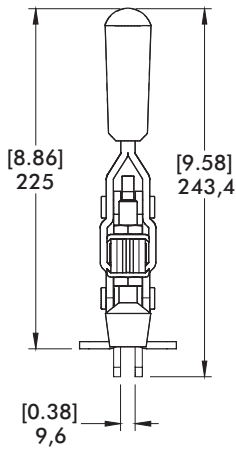
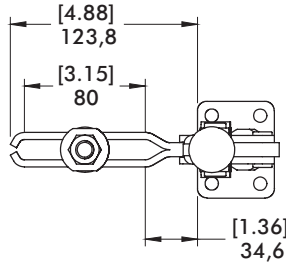
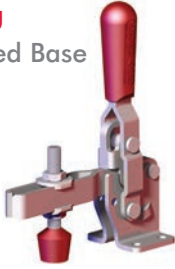

247-S
Flanged Base
Solid Bar

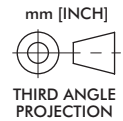
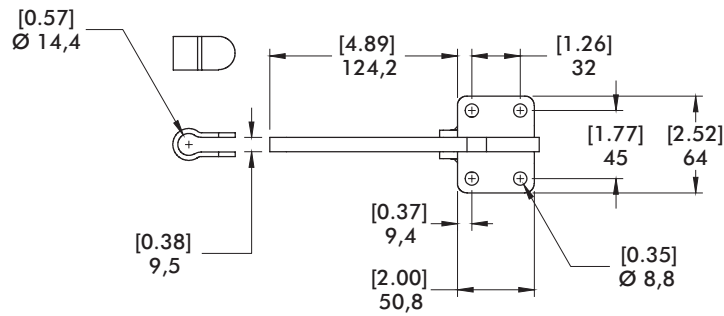

Series **267** Standard Clamp Dimensions
-U/-S

267-U
Flanged Base
U-Bar

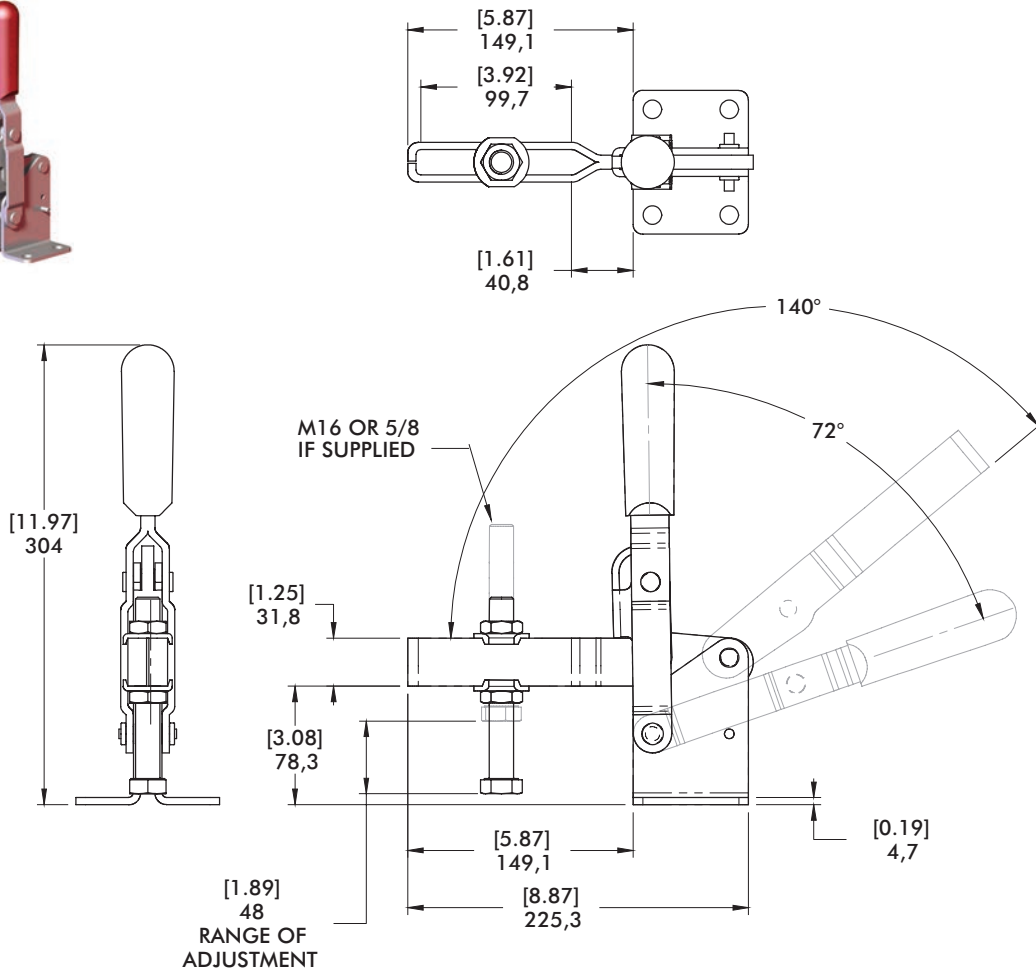
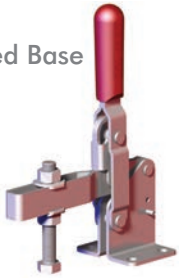

267-S
Flanged Base
Solid Bar

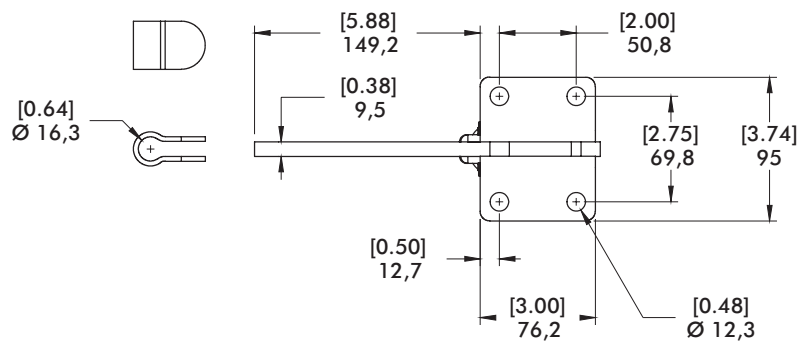

mm [INCH]
THIRD ANGLE PROJECTION

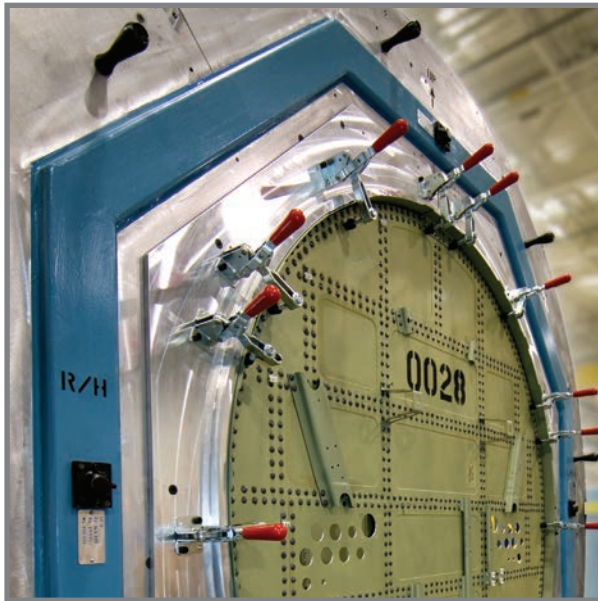

Model 210-U
used in an airframe
assembly fixture

Model 210-U
shown being used
in a checking fixture
application.

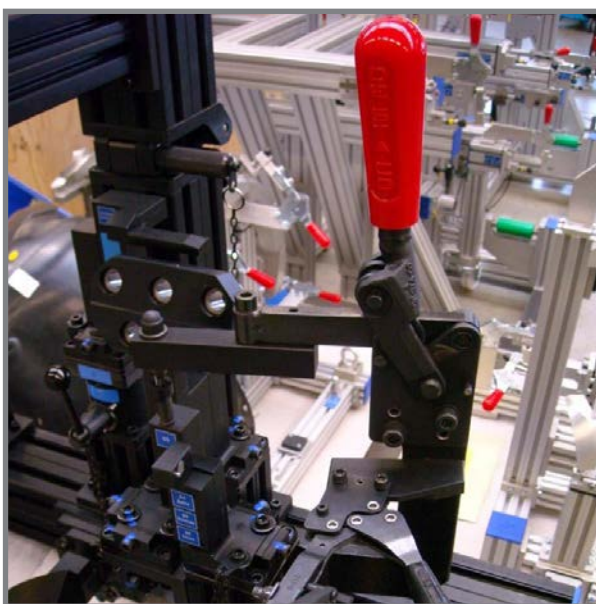

Model 533-LB
and **227-UB** shown
with black finish in
a fixture for used for
optical inspection.

Series 5905, 5910, 5915 Product Overview

Features:

- High strength forged clamping arm for heavy-duty service
- Hardened steel pivot pins and bushings provide long life
- Black oxide finish

Applications:

- Welding fixtures
- Assembly fixtures



5905/5910/5915
Flanged Base



5905-B/5910-B
Solid Base



Series 5905, 5910, 5915 Technical Information

Model	Max. Holding Capacity	Clamp Bar Opening (+10°)	Handle Opening (+10°)	Weight
5905	[750lbf.] 3340N	135°	70°	[1.08lbs] 0,49kg
5905-B				[0.82lbs] 0,37kg
5910	[1600lbf.] 7120N	132°	71°	[2.84lbs] 1,29kg
5910-B				[2.24lbs] 1,02kg
5915	[2750lbf.] 12230N	147°	74°	[6.44lbs] 2,92kg



Removable handle stop can be repositioned to limit opening angle to 90°

Series 5905, 5910, 5915 Standard Clamp Dimensions

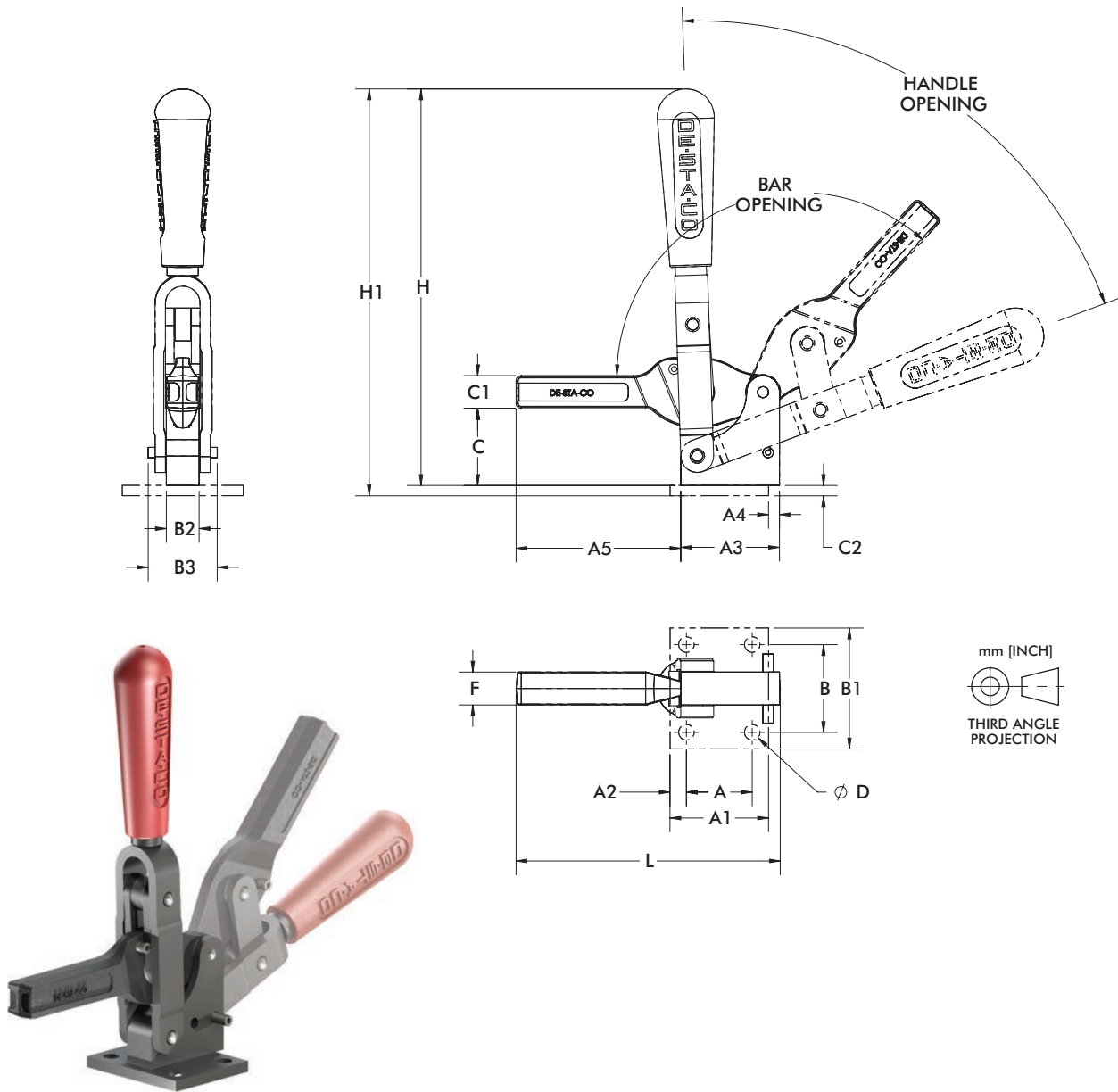

Model	A	A1	A2	A3	A4	A5	B	B1	B2	B3	C	C1	C2	D	F	H	H1	L
5905	[1.00] 25,4	[1.50] 38,1	[0.25] 6,4	[1.51] 38,4	[0.25] 6,4	[2.49] 63,2	[1.50] 38,1	[2.13] 54,1	[0.59] 15,0	[1.02] 25,9	[1.27] 32,3	[0.51] 12,9	[0.24] 6,1	[0.29] 7,3	[0.56] 14,2	[6.51] 165,4	[6.75] 171,4	[4.02] 102,10
5910	[1.50] 38,1	[2.24] 56,9	[0.37] 9,4	[2.25] 57,2	[0.25] 6,4	[3.76] 95,5	[2.00] 50,8	[2.76] 70,1	[0.75] 19,1	[1.57] 39,9	[1.75] 44,5	[0.75] 19,1	[0.24] 6,1	[0.41] 10,5	[0.75] 19,1	[9.04] 229,5	[9.27] 235,5	[6.02] 152,88
5915	[2.00] 50,8	[2.95] 74,9	[0.48] 12,2	[2.99] 75,9	[0.38] 9,7	[5.00] 127,0	[2.75] 69,9	[3.88] 98,6	[0.98] 24,9	[1.97] 50,0	[2.37] 60,2	[1.00] 25,4	[0.35] 8,9	[0.55] 14,0	[1.00] 25,4	[10.89] 276,7	[11.25] 285,7	[7.50] 190,50

Model	A3	A5	B2	B3
5905-B	[1.51] 38,4	[2.49] 63,2	[0.59] 15,0	[1.02] 25,9
5910-B	[2.25] 57,2	[3.76] 95,5	[0.75] 19,1	[1.57] 39,9

Series 5105, 5110 Product Overview

Features:

- High strength forged clamping arm for heavy-duty service
- Hardened steel pivot pins and bushings provide long life
- Black oxide finish
- Large clearance under the clamping bar
- DE-STA-CO® Toggle Lock Plus versions available†

Applications:

- Welding fixtures
- Assembly fixtures



Covered under one or more U.S./International Patents

5105/5110
Flanged Base



5105-B/5110-B
Solid Base



5105-R/5110-R
Flanged Base with DE-STA-CO® Toggle Lock Plus



5105-BR†/5110-BR†
Solid Base with DE-STA-CO® Toggle Lock Plus



Series 5105, 5110 Technical Information

Model	Max. Holding Capacity	Clamp Bar Opening (+10°)	Handle Opening (+10°)	Weight
5105	[700lbf.] 3100N	89°	159°	[1.12lbs] 0,51kg
5105-B				[1.06lbs] 0,48kg
5105-R				[1.10lbs] 0,50kg
5105-BR†				[1.17lbs] 0,53kg
5110	[1150lbf.] 5100N	74°	138°	[2.98lbs] 1,35kg
5110-B				[2.95lbs] 1,34kg
5110-R				[3.00lbs] 1,36kg
5110-BR†				[3.02lbs] 1,37kg

† This item is available upon request.

† Toggle Lock Plus locks the handle in the closed position only.

Series 5105, 5110 Standard Clamp Dimensions

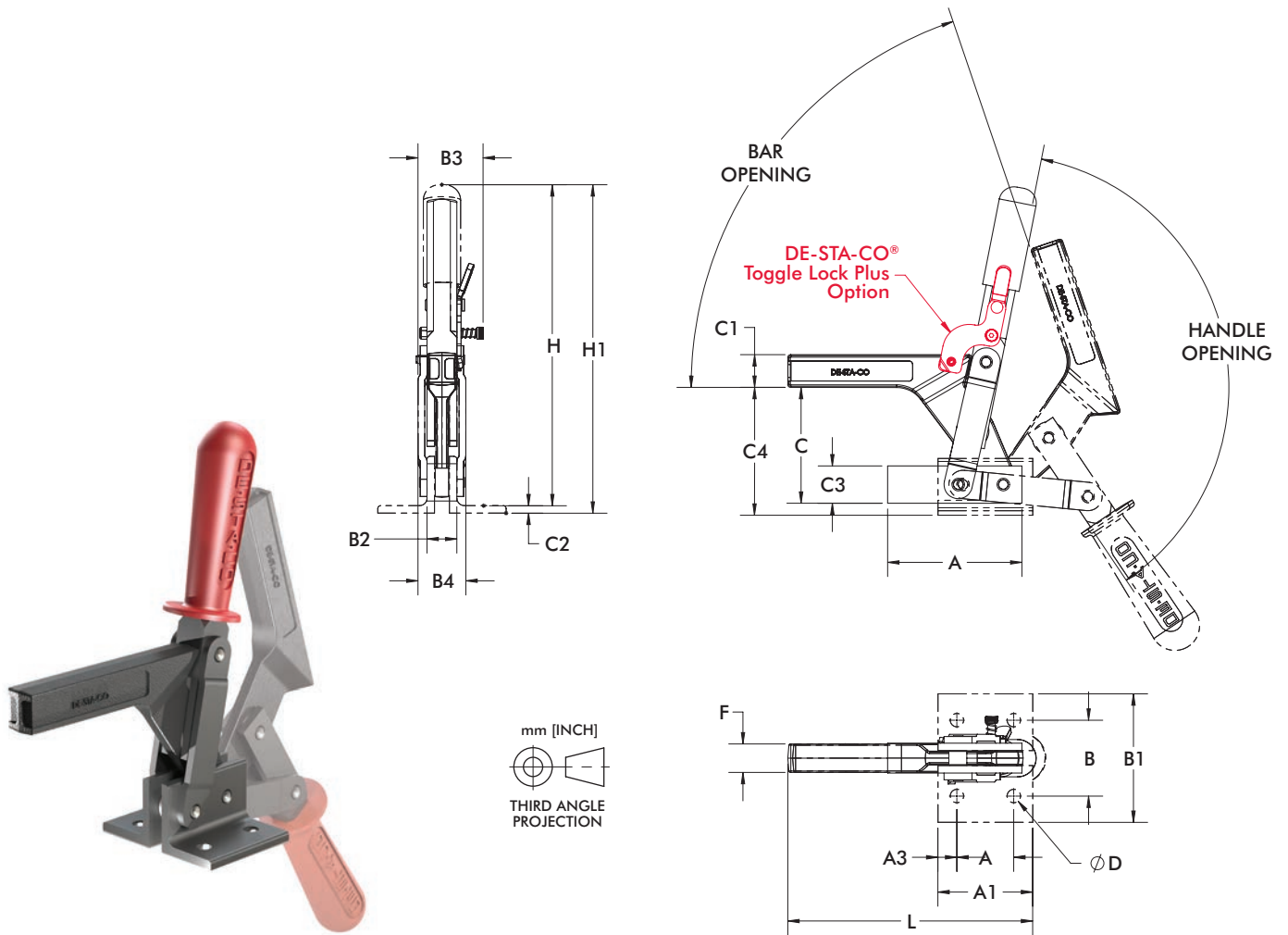

mm [INCH]
THIRD ANGLE PROJECTION

Model	A	A1	A2	B	B1	B2	B3	B4	C1	C2	C4	D	F	H1	L
5105	[1.00]	[1.62]	[0.31]	[1.46]	[2.24]	[0.59]	--	[0.98]	[0.51]	[0.16]	[2.54]	[0.26]	[0.56]	[6.54]	[4.13]
5105-R	25,4	41,2	7,9	37	57	15	[1.48]	25	13,0	4,0	64,6	6,6	14,3	166,1	104,9
5110	[1.50]	[2.50]	[0.50]	[2.00]	[2.76]	[0.79]	--	[1.26]	[0.87]	[0.20]	[3.37]	[0.35]	[0.75]	[8.70]	[6.33]
5110-R	38,1	63,5	12,7	50,8	70	20	[1.67]	32	22,0	5,0	85,6	9,0	19,1	221,1	160,9

Model	A3	B2	B3	B4	C	C1	C3	F	H
5105-B	[2.50]	[0.59]	--	[0.98]	[2.14]	[0.51]	[0.59]	[0.56]	[6.14]
5105-BR ⓘ	63,5	15	[1.48]	25	54,3	13,0	15,0	14,3	156,0
5110-B	[3.54]	[0.79]	--	[1.26]	[3.05]	[0.87]	[0.98]	[0.75]	[8.39]
5110-BR ⓘ	90	20	[1.67]	32	77,5	22,0	25,0	19,1	213,0

ⓘ This item is available upon request

Series 528 Product Overview

Features:

- Hardened steel bushings at pivot points for long life
- Solid bar may be modified to suit application requirements

Applications:

- Assembly & test
- Light machining
- Welding
- Medium to heavy duty clamping requirements

528
Flanged Base
Solid Bar

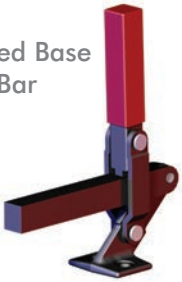

528-F ⓘ
Front Mount
Base Solid Bar



Series 528 Technical Information

Model	Max. Holding Capacity	Clamp Bar Opening (+10°)	Handle Opening (+10°)	Weight
528	4450 N [1000 lbf]	180°	177°	[2.50lbs] 1,13kg
528-F ⓘ				

ⓘ This item is available upon request

Series 528 Holding Capacities, Standard Clamp Dimensions

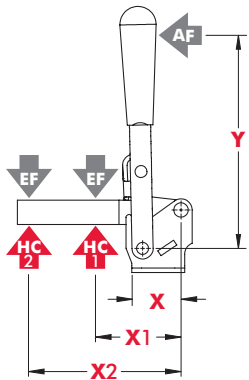

Model	X	X1	X2	Y	±HC1	±HC2	±EF(X1):AF	±EF(X2):AF
528	[1.38]	[3.50]	[6.00]	[5.50]	[1000lbf.]	[580lbf.]	23:1	12:1
528-F	35	89	152	140	4450N	2580N		

Dimensions shown "mm [inch]" ±HC = Holding Capacity, EF = Exerting Force, AF = Applied Force
Refer to page 14.4 for additional information.

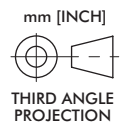
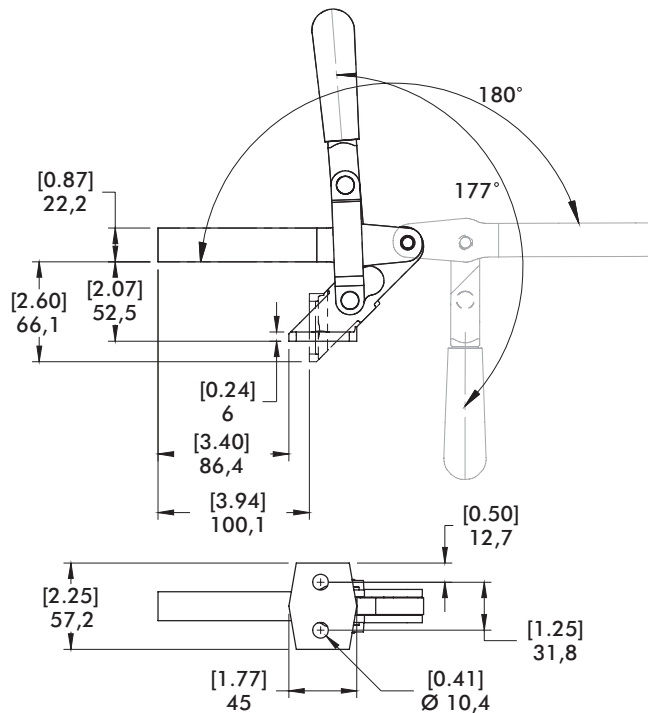
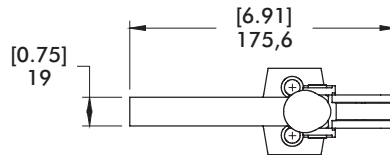
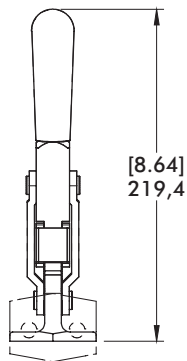

Series 548, 578 Product Overview

Features:

- Large bar guides for lateral stability
- Hardened steel pins and bushings for long life
- Replaceable pins

Applications:

- Assembly & test
- Light machining
- Welding
- Heavy duty clamping requirements

548
Straight Base
Solid Bar



578
Straight Base
Solid Bar



Series 548, 578 Technical Information

Model	Max. Holding Capacity	Clamp Bar Opening (+10°)	Handle Opening (+10°)	Weight
548	11100N [2500lbf]	199°	129°	2,40kg [5.30lbs]
578	17800N [4000lbf]			4,14kg [9.12lbs]

Series 548, 578 Holding Capacities, Standard Clamp Dimensions

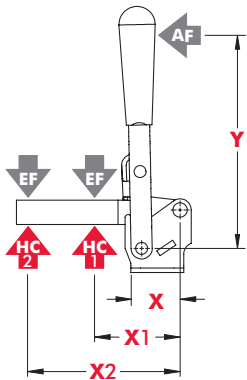

Model	X	X1	X2	Y	±HC1	±HC2	±EF(X1):AF	±EF(X2):AF
548	[2.75] 70	[3.50] 89	[6.00] 152	[7.50] 190	[2500lbf] 11100N	[1500lbf.] 6680N	4.5:1	3.4:1
578	[4.25] 108	[4.50] 114	[7.00] 178	[10.31] 262	[4000lbf] 17800N	[2500lbf.] 11100N	7.6:1	4.2:1

Dimensions shown "mm [inch]" ± HC = Holding Capacity, EF = Exerting Force, AF = Applied Force
Refer to page 14.4 for additional information.

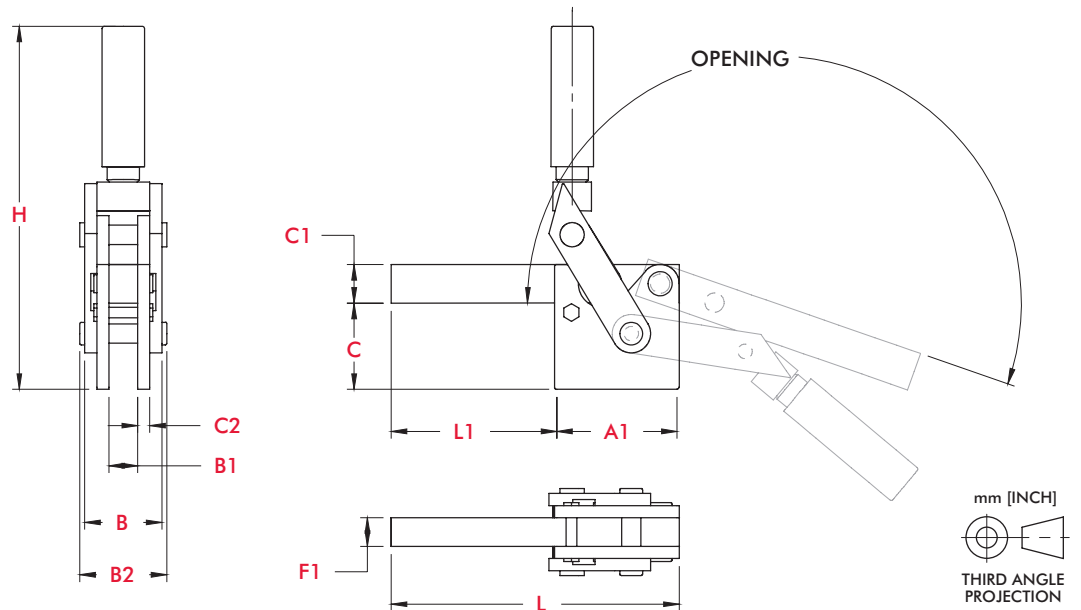

mm [INCH]
THIRD ANGLE PROJECTION

Model	A1	B	B1	B2	C	C1	C2	F1	H	L	L1
548	[3.25] 82,6	[2.01] 51	[0.75] 19,1	[2.26] 57,5	[2.24] 56,9	[1.00] 25,4	[0.31] 7,9	[0.75] 19,1	[9.45] 240	[7.50] 190,5	[4.25] 107,9
578	[4.02] 102,1	[2.38] 60,5	[0.87] 22,1	[2.70] 68,6	[2.79] 70,9	[1.26] 32	[0.37] 9,5	[0.87] 22,1	[11.04] 280,3	[8.62] 219	[4.61] 117,1

Series 533, 535 Product Overview

Features:

- Hardened steel bushings and pivot pins
- Large bar guides for greater lateral support
- Solid clamping bar may be modified to suit application requirements

Applications:

- Welding
- Heavy duty clamping applications

Also Available:

See page 7.1 for accessories

533-L
Flanged Base
Solid Bar



533-LB
Straight Base
Solid Bar



535-L
Flanged Base
Solid Bar



535-LB
Straight Base
Solid Bar



Series 533, 535 Technical Information

Model	Max. Holding Capacity	Clamp Bar Opening (+10°)	Handle Opening (+10°)	Weight	Accessories (Supplied)
					Bolt Retainer
533-L	7000 N [1575 lbf]	120°	90°	1,00kg [2.20lbs]	533108-M
533-LB					
535-L	10000 N [2250 lbf]			1,85kg [4.087lbs]	535108-M
535-LB					

Series 533, 535 Standard Clamp Dimensions -L/-LB

533-L
Flanged Base
Solid Bar

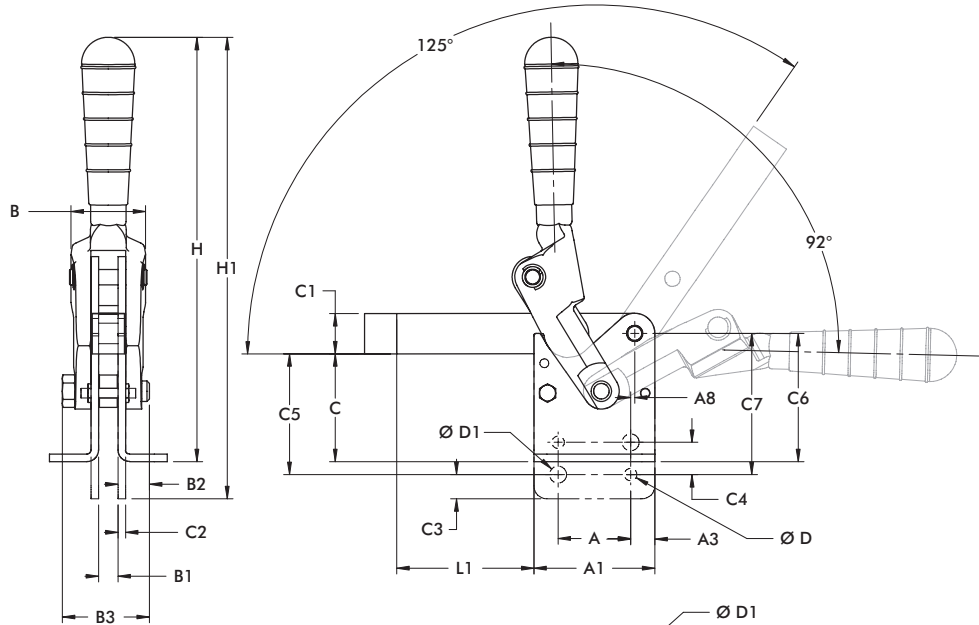
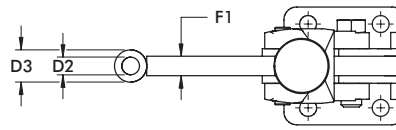

535-L
Flanged Base
Solid Bar

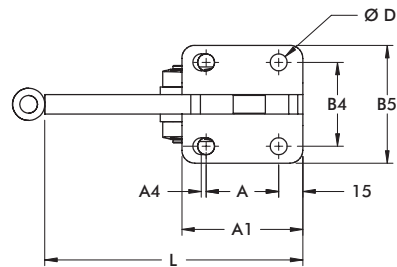

mm [INCH]
THIRD ANGLE PROJECTION

Model	A	A1	A3	A4	A8	B	B1	B2	B3	B4	B5	C	C1	C2
533-L	[1.18] 30	[2.36] 59,9		[0.08] 2	[0.20] 5,1	[1.52] 38,6	[0.39] 9,9	[0.69] 15,5	[1.75] 44,5	[1.77] 45	[2.44] 62	[1.86] 47,2	[0.79] 20,1	
533-LB			[0.59] 15							--	--	--		[0.19] 4,8
535-L	[1.77] 45	[2.95] 74,9		--	[0.18] 4,6	[1.89] 48	[0.47] 11,9	[0.89] 22,6	[2.13] 54,1	[2.05] 52,1	[2.87] 72,9	[2.63] 66,8	[0.98] 24,9	
535-LB										--	--	--		

Model	C3	C4	C5	C6	C7	D	D1	D2	D3	F1	H	H1	L	L1
533-L	--	--	--	[2.24] 56,9	--	--	[0.33] 8,4	[0.35] 8,9	[0.59] 15	[0.39] 9,9	[8.6] 218,4	--	[4.92] 125	[2.56] 65
533-LB	[0.39] 9,9	[0.59] 15	[1.86] 55,1	--	[2.56] 65	[0.22] 5,6					--	[9.31] 236,5		
535-L	--	--	--	[3.13] 79,5	--	--	[0.41] 10,4	[0.43] 10,9	[0.79] 20,1	[0.47] 11,9	[10.35] 262,9	--	[6.30] 160	[3.35] 85,1
535-LB	[0.59] 15	[0.79] 20,1	[2.95] 74,9	--	[3.44] 87,4	[0.30] 7,6					--	[11.26] 286		

Series 558 Product Overview

Features:

- Forged alloy steel handle and links for rugged service
- Hardened steel pins and bushings
- Hold down bar can be machined to suit application requirements

Applications:

- Welding
- Heavy duty clamping requirements

Also Available:

Model 858 Pneumatic Toggle clamp
See page 9.17

558



Series 558 Technical Information

Model	Max. Holding Capacity	Clamp Bar Opening (+10°)	Handle Opening (+10°)	Weight
558	11100 N [2500 lbf]	192°	64°	2,27kg [5.0lbs]

Series 558 Holding Capacities, Standard Clamp Dimensions

Model	X	X1	±HC1	±HC2
558	65,8 [2.59]	76,2 [3.00]	[2500 lbf] 11100 N	[1500 lbf] 6680 N

Dimensions shown "mm [inch]", ± HC = Holding Capacity

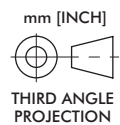
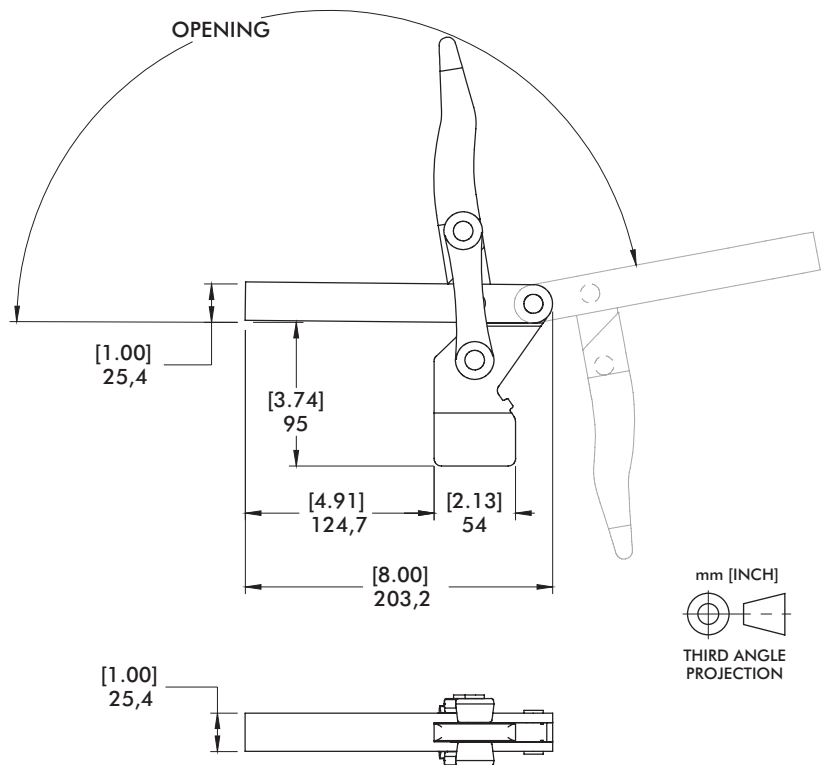
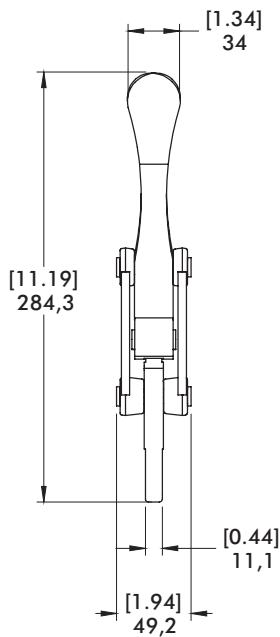
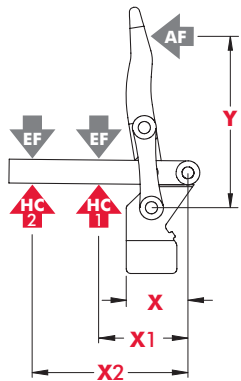



Series 91090 Product Overview

Features:

- Front flange mount
- Accepts M8 or 5/16" spindle accessory (not supplied)

Applications:

- Assembly & test
- Checking fixtures
- Light machining
- Woodworking

Also Available:

See page 7.1 for accessories

91090
Front Flanged Base
Open Bar



Series 91090 Technical Information, Standard Clamp Dimensions

Model	Max. Holding Capacity	Clamp Bar Opening (+10°)	Handle Opening (+10°)	Weight	Recommended Accessories		
					Bolt Retainer	Spindle Assembly	Flanged Washers
91090	1710 N [385 lbf]	100°	60°	0,37kg [0.81lbs]	---	507208-M	507107

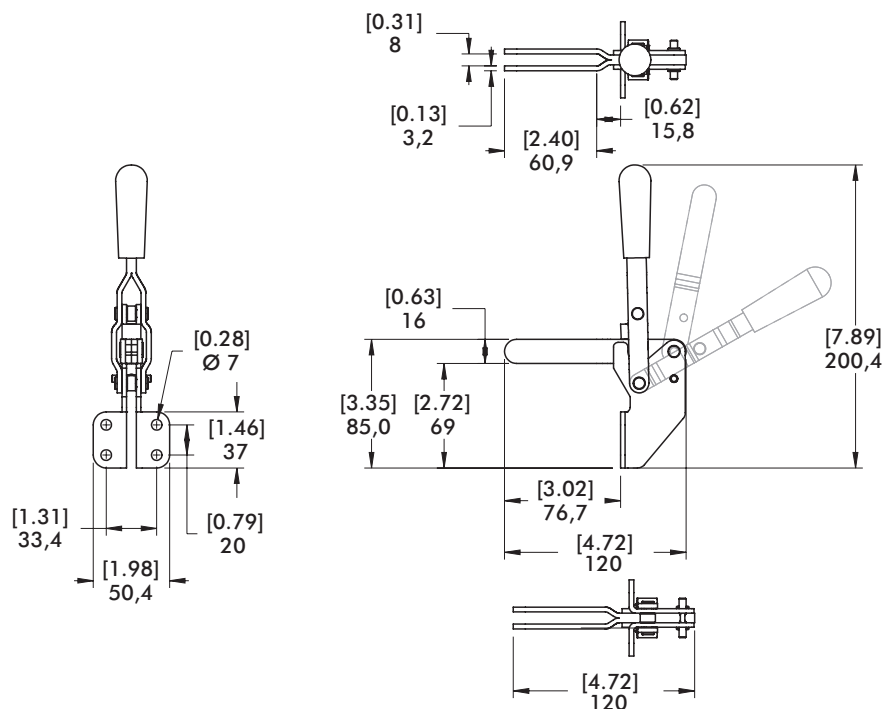

Series 317 Product Overview

Features:

- Dual mounting surfaces
- Large bar opening angle
- Accommodates M8 or 5/16" spindle accessories

Applications:

- Assembly & test
- Checking fixtures
- Light machining
- Woodworking

Also Available:

See page 7.1 for accessories
 817-U Pneumatic Toggle Clamp
 (See page 9.21)
 817-S Pneumatic Toggle Clamp
 (See page 9.21)



Note:
 Clamps shown with included accessories.

Series 317 Technical Information

Model	Max. Holding Capacity	Clamp Bar Opening (+10°)	Handle Opening (+10°)	Weight	Accessories (Supplied)		
					Bolt Retainer	Spindle Assembly	Flanged Washers
317-U	1670 N [375 lbf]	185°	60°	0,34kg [0.75lbs]	---	507208-M	507107
317-S	1780 N [400 lbf]				207105	---	---

Series 317 Holding Capacities

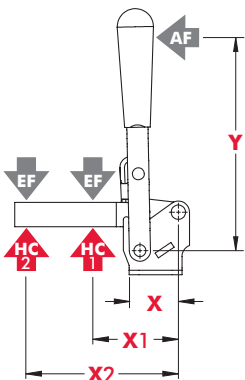

Model	X	X1	X2	Y	±HC1	±HC2	±EF(X1):AF	±EF(X2):AF
317-U	[1.57]	[2.00] 50,8	[3.75] 95,3	[4.00]	[375 lbf] 1670 N	[200lbf.] 900N	17:1	8:1
317-S	40,0	[2.50] 63,5	[5.00] 127,0	101,6	[400 lbf] 1780 N	[190lbf.] 850N	13:1	5:1

Dimensions shown "mm [inch]" ± HC = Holding Capacity, EF = Exerting Force, AF = Applied Force
 Refer to page 14.4 for additional information.

Series 317 Standard Clamp Dimensions -U/-S

317-U
U-Bar

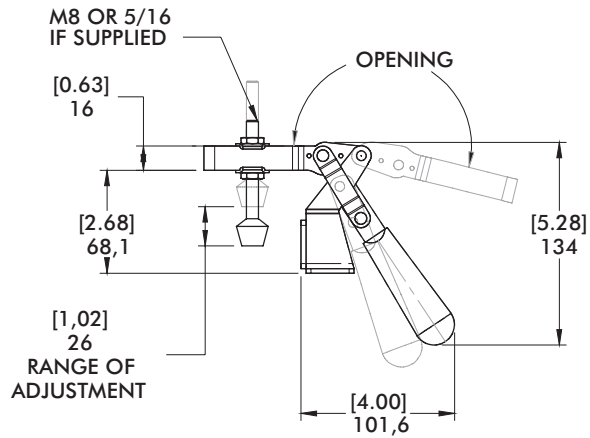
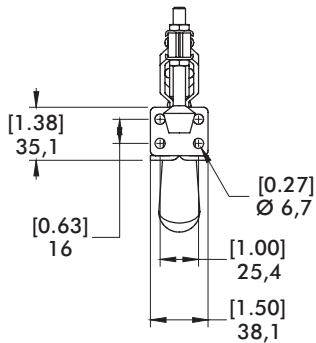
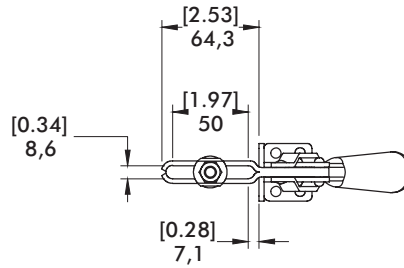

317-S
Solid Bar

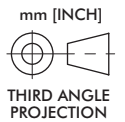
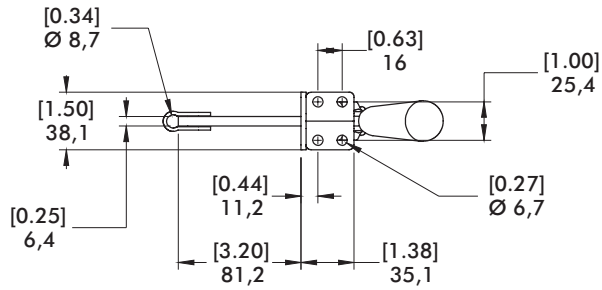
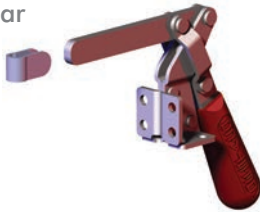

Series 527 Product Overview

Features:

- Hardened steel bushings at pivot points
- Solid bar can be modified to suit application requirements
- Thumb lever on link for easy opening

Applications:

- Assembly & test
- Light machining
- Woodworking

527
Flanged Base



527-F ⓘ
Front Mount



Series 527 Technical Information

Model	Max. Holding Capacity	Clamp Bar Opening (+10°)	Handle Opening (+10°)	Weight
527	4450 N [1000 lbf]	195°	65°	[2.50lbs] 1,13kg
527-F ⓘ				

ⓘ This item is available upon request

Series 527 Holding Capacities, Standard Clamp Dimensions

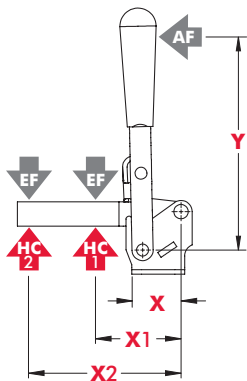

Model	X	X1	X2	Y	±HC1	±HC2	±EF(X1):AF	±EF(X2):AF
527	[3.12] 79,2	[3.50] 89,0	[6.00] 152,4	[4.00] 101,6	[1000lbf.]	[580lbf.]	23:1	12:1
527-F	[2.53] 64,3				4450N	2580N		

Dimensions shown "mm [inch]" ± HC = Holding Capacity, EF = Exerting Force, AF = Applied Force
Refer to page 14.4 for additional information.

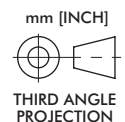
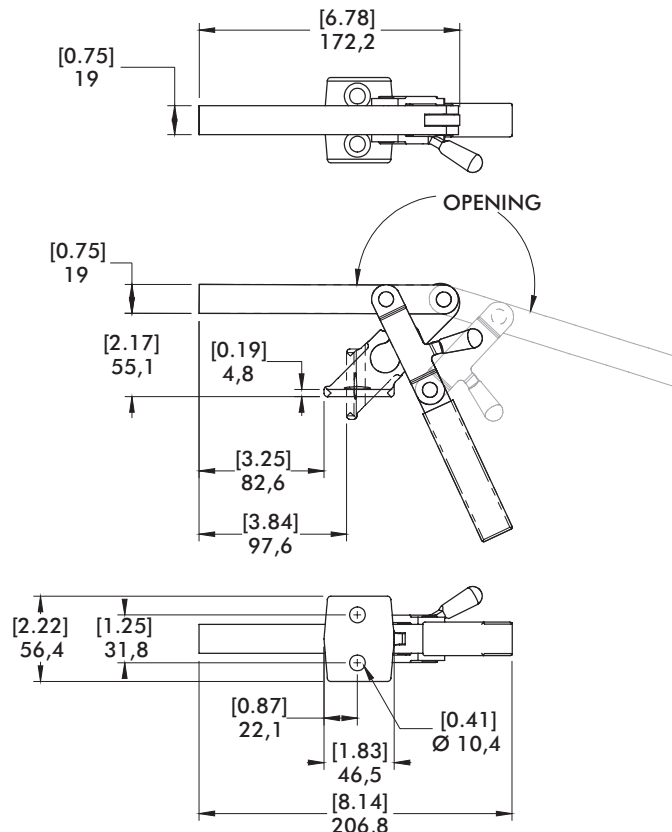
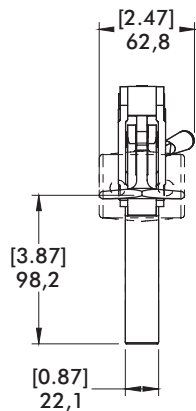

Heavy Duty Cam Action Series Product Overview

Features:

- Cam action accommodates variable workpiece thickness
- Heavy duty construction
- Solid clamp arms may be modified to suit application requirements

Applications:

- Light machining
- Welding
- Assembly

7-101



7-58



Technical Information

Model	Max. Holding Capacity	Clamp Bar Opening (+10°)	Weight
7-101	2110 N [475 lbf]	80°	0,45kg [1.0lbs]
7-58	2670 N [600 lbf]	95°	0,91kg [2.0lbs]
7-59	4450 N [1000 lbf]	95°	1,36kg [3.0lbs]
7-60	7120 N [1600 lbf]	80°	2,27kg [5.0lbs]

Heavy Duty Cam Action Series Standard Clamp Dimensions - Flanged Base

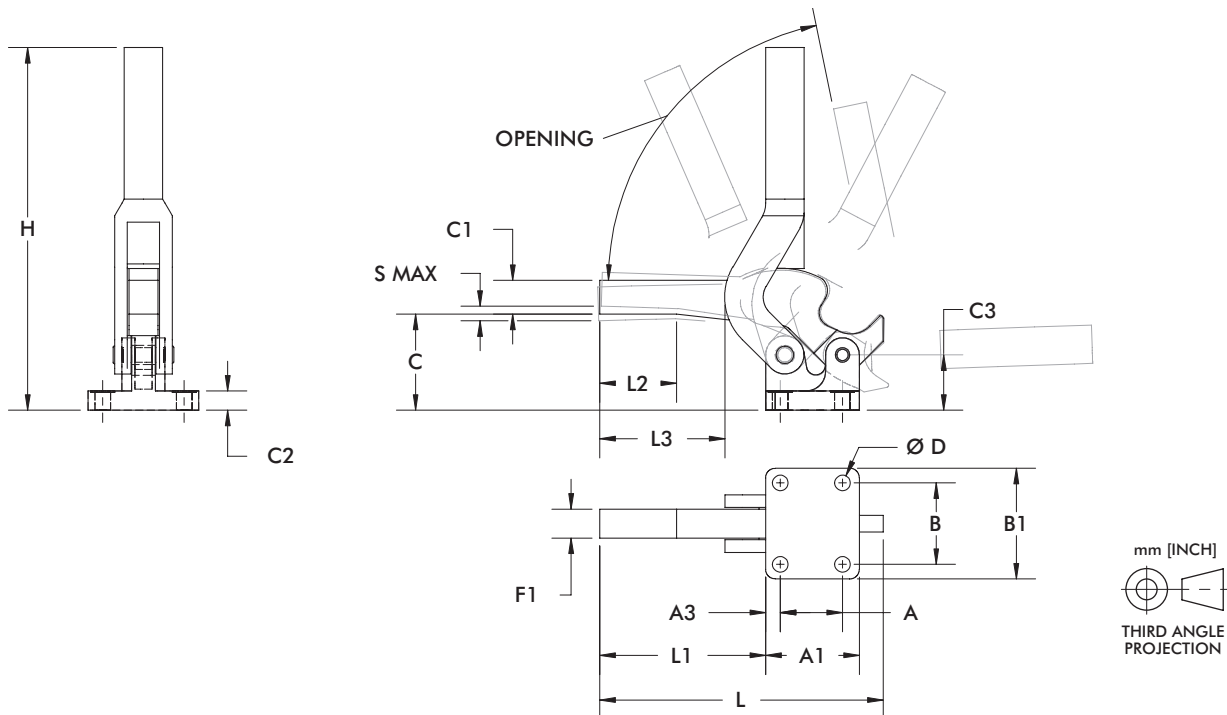

Model	A	A1	A3	B	B1	C	C1	C2	C3	D	F1	H	L	L1	L2	S max.
7-101	[0.75] 19,1	[1.25] 31,8	[0.25] 6,1	[1.25] 31,8	[1.75] 44,5	[1.44] 36,6	[0.50] 12,7	[0.31] 7,9	[1.00] 25,4	[0.22] 5,6	[0.50] 12,7	[5.00] 127	[4.63] 117,6	[3.12] 79,3	-	[0.13] 3,3
7-58	[1.00] 25,4	[1.69] 42,9	[0.34] 8,6	[1.62] 41,2	[2.25] 57,2	[1.87] 47,5	[0.56] 14,2	[0.38] 9,7	[1.12] 28,5	[0.28] 7,1	[0.50] 12,7	[7.00] 177,8	[6.99] 177,6	[2.55] 64,8	-	[0.13] 3,3
7-59	[1.38] 35,1	[2.06] 52,3	[0.39] 9,9	[1.88] 47,8	[2.50] 63,5	[2.19] 55,6	[0.63] 16	[0.44] 11,2	[1.25] 31,8	[0.34] 8,6	[0.63] 16	[8.50] 215,9	[6.00] 152,4	[3.50] 88,9	[1.24] 31,5	[0.19] 4,8
7-60	[1.62] 41,2	[2.44] 62	[0.44] 11,2	[2.12] 53,9	[2.88] 73,2	[2.50] 63,5	[0.88] 22,4	[0.50] 12,7	[1.44] 36,6	[0.41] 10,4	[0.75] 19,1	[9.50] 241,3	[7.40] 188	[4.38] 111,3	[1.97] 50	[0.25] 6,4

Series 229 Product Overview

Features:

- Cam action clamp holds workpieces of varying height
- Total clamping range of 8mm [.31in.]
- Accommodates M12 or 1/2" accessories

Applications:

- Assembly & test
- Light machining
- Welding

Also Available:

See page 7.1 for accessories

229
Flanged Base
Open Bar

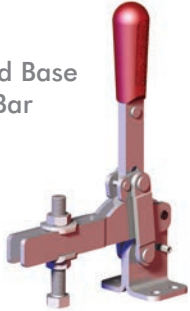

Series 229 Technical Information

Model	Max. Holding Capacity	Clamp Bar Opening (+10°)	Handle Opening (+10°)	Weight	Accessories (Supplied)	
					Spindle Assembly	Flanged Washers
229	4450 N [1000 lbf]	115°	180°	1,17kg [2.59lbs]	229203	247109

Series 229 Holding Capacities

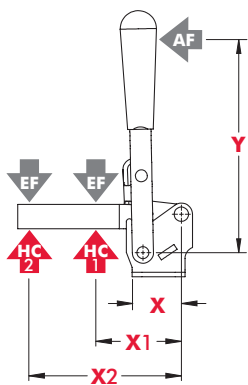

Model	X	X1	X2	Y	‡HC1	‡HC2	‡EF(X1):AF	‡EF(X2):AF
229	[1.53] 38,9	[3.00] 76,2	[6.12] 155,4	[7.06] 179,3	[1000lbf.] 4450N	[500lbf.] 2230N	7:1	3:1

Dimensions shown "mm [inch]" ‡ HC = Holding Capacity, EF = Exerting Force, AF = Applied Force
Refer to page 14.4 for additional information.

Series 229 Standard Clamp Dimensions

229
Flanged Base
Open Bar

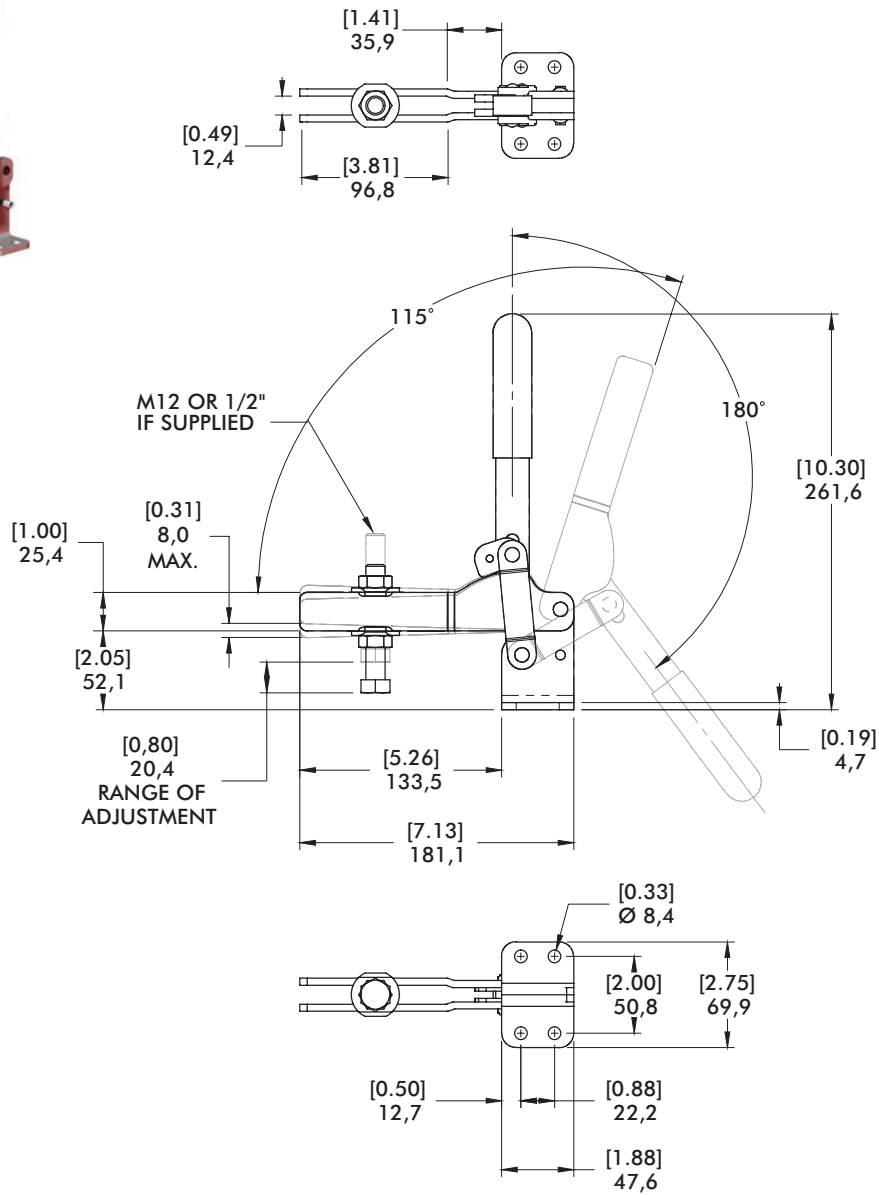
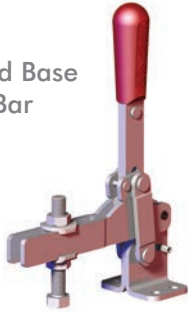

Series 500 Product Overview

Features:

- Hardened pivot pins and bushings
- Weldable clamping bar
- LSC version with locking spring clip for securing the handle in the open position
- Modular design allows you to set up the clamp to meet application requirements

Applications:

- Welding
- Assembly
- Heavy duty, production clamping applications

Also Available:

See page 1.46 for accessories

501-**B** ⓘ
Swivel Base



501-**LB** ⓘ
Long Base



503-**MB**
Swivel Base



503-**MLB**
Long Base



503-**MBLSC** ⓘ
Swivel Base
with Locking
Spring Clip



503-**MLB LSC** ⓘ
Long Base
with Locking
Spring Clip



505-**MB**
Swivel Base



505-**MLB**
Long Base



505-**MB LSC** ⓘ
Swivel Base
with Locking
Spring Clip



505-**MLB LSC** ⓘ
Long Base
with Locking
Spring Clip



506-**MB**
Swivel Base



506-**MLB** ⓘ
Long Base



506-**MB LSC** ⓘ
Swivel Base
with Locking
Spring Clip



506-**MLB LSC** ⓘ
Long Base
with Locking
Spring Clip



Model 505-MLB in a robotic welding fixture

ⓘ This item is available upon request

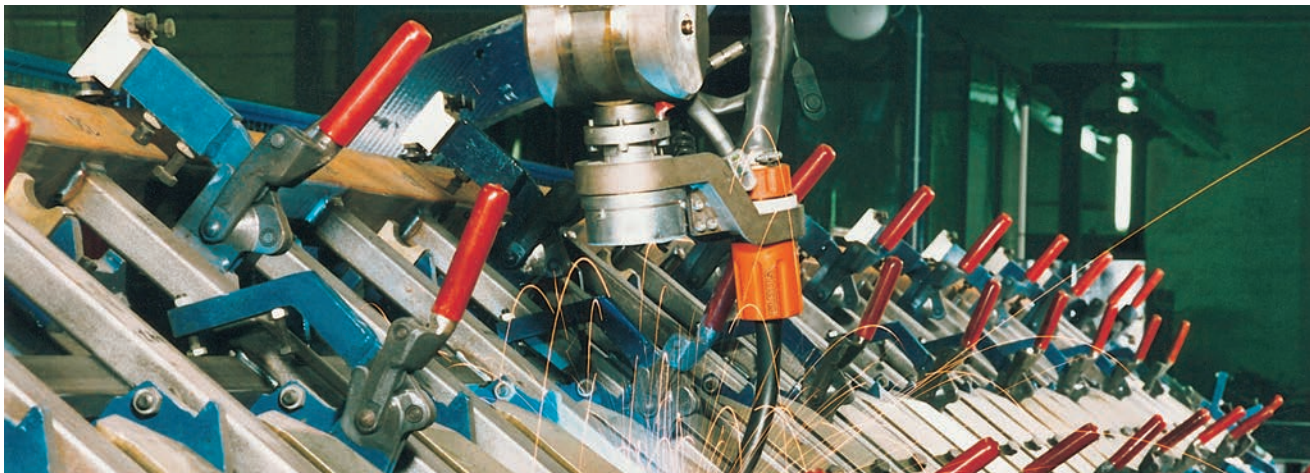

Series 500 Technical Information

Model	Max. Holding Capacity	Clamp Bar Opening (+10°)	Weight
501-B ⓘ	2000 N [450 lbf]	200°	0,18kg [0.40lbs]
501-LB ⓘ			0,20kg [0.44lbs]
503-MB	7000 N [1575 lbf]		0,70kg [1.54lbs]
503-MLB			0,80kg [1.76lbs]
503-MBLSC ⓘ			
503-MLBLSC ⓘ	0,90kg [1.98lbs]		
505-MB	11000 N [2475 lbf]		1,40kg [3.09lbs]
505-MLB			1,50kg [3.31lbs]
505-MBLSC ⓘ			
505-MLBLSC ⓘ			
506-MB	22500 N [5060 lbf]	2,60kg [5.73lbs]	
506-MLB ⓘ		2,80kg [6.17lbs]	
506-MBLSC ⓘ			
506-MLBLSC ⓘ			3,00kg [6.61lbs]

Note:

The clamping bars are made from forged alloy steel and must be heated to 200°C(400°F) prior to welding. We recommend welding the handles, clamp arms, and mounting bases when disassembled. Welding of non pre-heated parts may only be done with the addition of welding fillers.

ⓘ This item is available upon request

Clamping Position

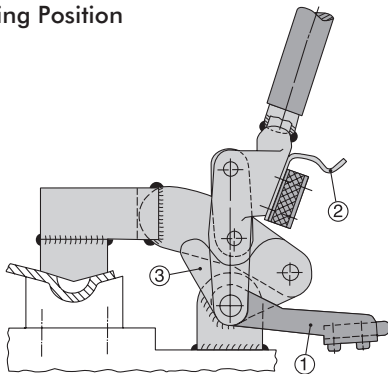

Patented spring latch hold-open device

1. Mount the clamp and place it in the closed position
2. Position the bracket in the leaf spring

Open Position

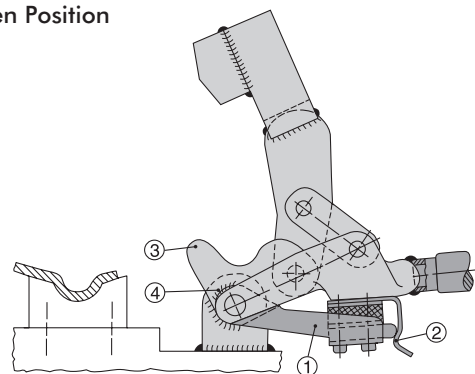

3. Swivel the clamp into the open position
4. In this position, weld the bracket with the bar guide feature at point

Series 500 Standard Clamp Dimensions
-B/-LB/-MB/-MLB/-MBLSC/-MLBLSC

Swivel Base

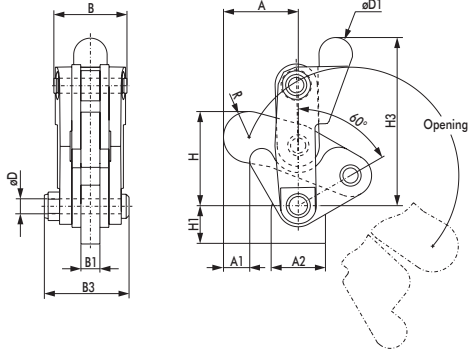

503-MB
Swivel Base

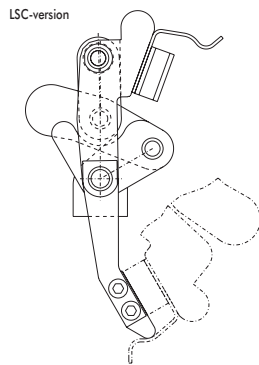

Long Base

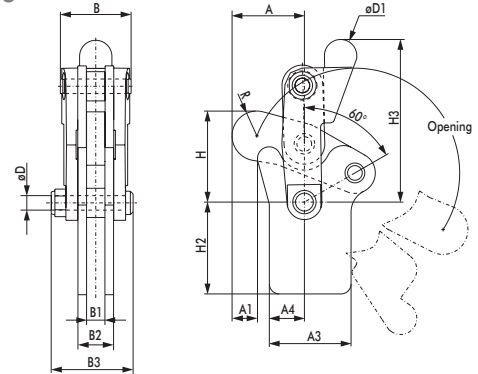

503-MLB
Long Base

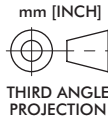
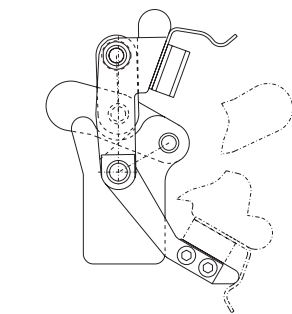

Swivel Base Dimensions

Model	A	A1	A2	B	B1	B3	ØD	ØD1	H	H1	H3	R
501-B ⓘ	[1.13] 28,6	[0.56] 14,3	[0.75] 19,1	[0.79] 20,0	[0.25] 6,4	[1.09] 27,8	[0.19] 4,8	[0.50] 12,7	[1.12] 28,5	[0.79] 20	[2.20] 56	[0.37] 9,5
503-MB 503-MBLSC ⓘ	[1.54] 39,2	[0.50] 12,8	[1.12] 28,5	[1.52] 38,5	[0.39] 10	[1.82] 46,2	[0.31] 8	[0.69] 17,5	[1.96] 49,8	[0.79] 20	[3.51] 89,1	[0.53] 13,5
505-MB 505-MBLSC ⓘ	[2.22] 56,5	[1.02] 25,9	[1.38] 35	[1.89] 48	[0.48] 12,3	[2.31] 58,6	[0.37] 9,5	[0.87] 22,2	[2.79] 70,8	[1.10] 28	[4.33] 110,1	[0.72] 18,3
506-MB 506-MBLSC ⓘ	[2.82] 71,7	[1.27] 32,3	[1.97] 50	[1.91] 48,4	[0.63] 16	[2.72] 69	[0.47] 12	[0.94] 24	[3.45] 87,7	[1.29] 32,8	[5.30] 134,6	[0.84] 21,4

Long Base Dimensions

Model	A	A1	A3	A4	B	B1	B2	B3	ØD	ØD1	H	H2	H3	R
501-LB ⓘ	[1.13] 28,6	[0.50] 12,8	[1.13] 28,6	[0.56] 14,3	[0.79] 20	[0.25] 6,4	[0.51] 13	[1.09] 27,8	[0.19] 4,8	[0.50] 12,7	[1.12] 28,5	[1.32] 33,5	[2.21] 56,1	[0.37] 9,5
503-MLB 503-MLBLSC ⓘ	[1.54] 39,2	[0.50] 12,8	[1.75] 44,5	[0.75] 19	[1.52] 38,5	[0.39] 10	[0.79] 20	[1.82] 46,2	[0.31] 8	[0.69] 17,5	[1.96] 49,8	[1.97] 50	[3.51] 89,1	[0.53] 13,5
505-MLB 505-MLBLSC ⓘ	[2.22] 56,5	[1.02] 25,9	[2.09] 53	[1.08] 27,5	[1.89] 48	[0.48] 12,3	[0.88] 22,3	[2.31] 58,6	[0.37] 9,5	[0.87] 22,2	[2.79] 70,8	[2.50] 63,5	[4.33] 110,1	[0.72] 18,3
506-MLB 506-MLBLSC ⓘ	[2.82] 71,7	[1.27] 32,3	[2.58] 65,5	[1.45] 36,9	[1.91] 48,4	[0.63] 16	[1.10] 28	[2.72] 69	[0.47] 12	[0.94] 24	[3.45] 87,7	[3.00] 76,2	[5.30] 134,6	[0.84] 21,4 [8.43] 214

Features:

- Used with 500 Series Vertical Clamps
- Allows you to customize the clamp to suit application requirements

Applications:

- Welding
- Assembly
- Heavy duty, production clamping applications

Also Available:

See page 1.43 for clamp linkage

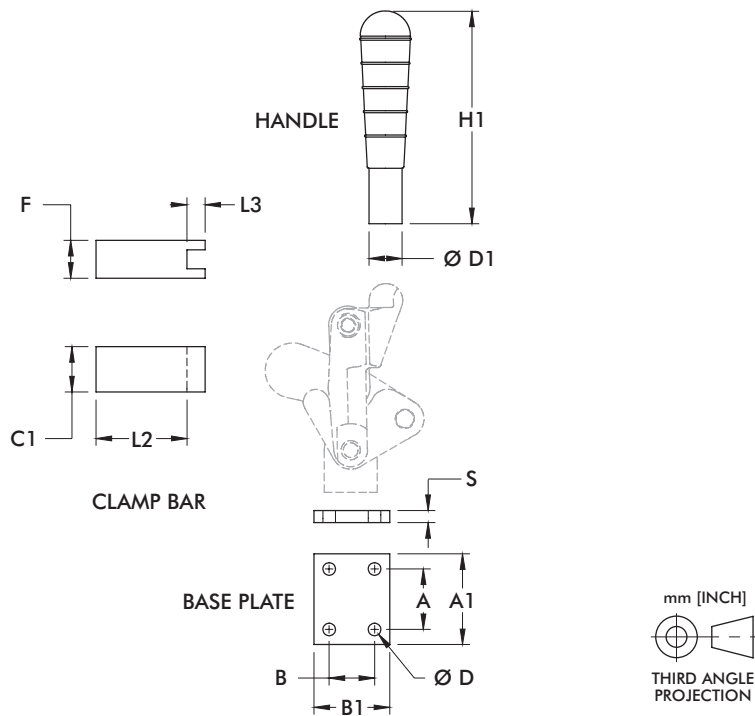

Use with	Part No.	Handle						Clamping Bar				Base Plate			
		ØD1	H1	C1	F	L2	L3	A	A1	B	B1	ØD	S		
501	501503 ⓘ	6x10	61	-	-	-	-	-	-	-	-	-	-		
	501501 ⓘ	-	-	15	15	40	10	-	-	-	-	-	-		
	503502	-	-	-	-	-	-	25	40	35	50	6.3	8		
503	503503-L	Ø18	129.5	-	-	-	-	-	-	-	-	-	-		
	503501	-	-	25	20	50	8	-	-	-	-	-	-		
	503502	-	-	-	-	-	-	25	40	35	50	6.3	8		
505	505503-L	Ø22	159	-	-	-	-	-	-	-	-	-	-		
	505501	-	-	30	25	60	12	-	-	-	-	-	-		
	505502	-	-	-	-	-	-	40	60	30	50	8.1	8		
506	506503-L	Ø28	188	-	-	-	-	-	-	-	-	-	-		
	506501	-	-	35	30	75	15	-	-	-	-	-	-		
	506502	-	-	-	-	-	-	50	70	45	65	8.1	8		

ⓘ This item is available upon request Note: Dimensions shown in millimeters.